

TECHNICAL
INFORMATION
*TECHNISCHE
INFORMATIONEN*



NEWS 2019

THE NEW CLASSIC	4
CLEANET	16
SONAR	18
KARTELL BY LAUFEN	25
VAL	28
LAUFEN PRO	31
PALACE	37
INO	39
LEELO	43
SENSE	53
QUADRIGA	56

THE NEW CLASSIC

815852

Small Washbasin

Handwaschbecken

500 x 450 x 135 mm

Farben: .000 .400 .757

Optionen: .104 .109

Available from 2nd Quarter 2019

Verfügbar ab 2. Quartal 2019

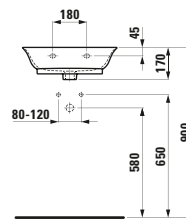
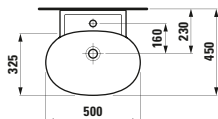

816852

Small washbasin, undersurface ground

Aufsatz-Handwaschbecken

500 x 450 x 135 mm

Farben: .000 .400 .757

Optionen: .104 .109

Available from 2nd Quarter 2019

Verfügbar ab 2. Quartal 2019

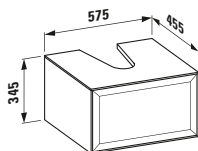
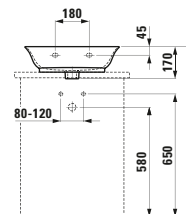
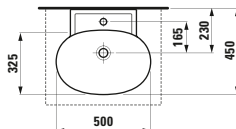

406003

Drawer element 600, 1 drawer, with centre cut-out

Schubladenelement 600, 1 Schublade, mit Ausschnitt Mitte

580 x 450 x 350 mm

Farben: .631 .627 .628

Available from 2nd Quarter 2019

Verfügbar ab 2. Quartal 2019

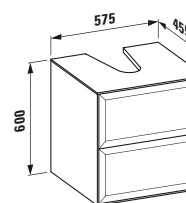

406004

Drawer element 600, 2 drawer, with centre cut-out

Schubladenelement 600, 2 Schublade, mit Ausschnitt Mitte

580 x 450 x 600 mm

Farben: .631 .627 .628

Available from 2nd Quarter 2019

Verfügbar ab 2. Quartal 2019

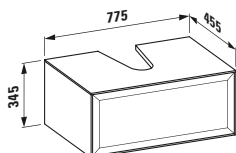

406013

Drawer element 800, 1 drawer, with centre cut-out

Schubladenelement 800, 1 Schublade, mit Ausschnitt Mitte

780 x 450 x 350 mm

Farben: .631 .627 .628

Available from 2nd Quarter 2019

Verfügbar ab 2. Quartal 2019

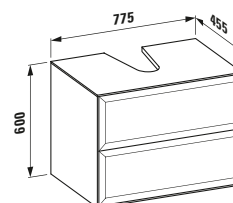

406014

Drawer element 800, 2 drawer, with centre cut-out

Schubladenelement 800, 2 Schublade, mit Ausschnitt Mitte

780 x 450 x 600 mm

Farben: .631 .627 .628

Available from 2nd Quarter 2019

Verfügbar ab 2. Quartal 2019

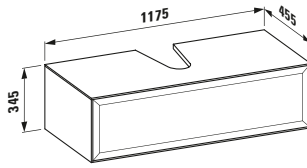

406023

Drawer element 1200, 1 drawer, with centre cut-out

Schubladenelement 1200, 1 Schublade, mit Ausschnitt Mitte

1180 x 450 x 350 mm

Farben: .631 .627 .628

Available from 2nd Quarter 2019

Verfügbar ab 2. Quartal 2019

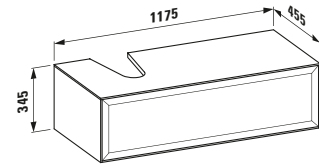

406085

Drawer element 1200, 1 drawer, cut-out left

Schubladenelement 1200, 1 Schublade, Ausschnitt links

1180 x 450 x 350 mm

Farben: .631 .627 .628

Available from 2nd Quarter 2019

Verfügbar ab 2. Quartal 2019

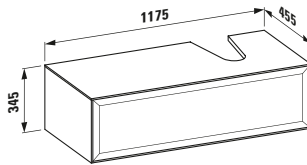

406086

Drawer element 1200, 1 drawer, cut-out right

Schubladenelement 1200, 1 Schublade, Ausschnitt rechts

1180 x 450 x 350 mm

Farben: .631 .627 .628

Available from 2nd Quarter 2019

Verfügbar ab 2. Quartal 2019

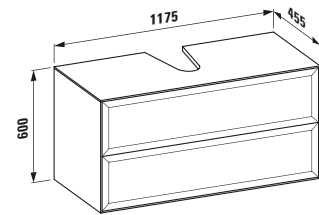

406024

Drawer element 1200, 2 drawer, with centre cut-out

Schubladenelement 1200, 2 Schubladen, mit Ausschnitt Mitte

1180 x 450 x 600 mm

Farben: .631 .627 .628

Available from 2nd Quarter 2019

Verfügbar ab 2. Quartal 2019

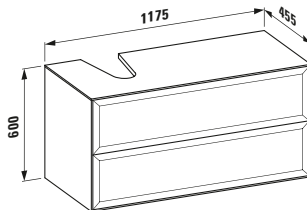

406087

Drawer element 1200, 2 drawers, cut-out left

Schubladenelement 1200, 2 Schubladen, Ausschnitt links

1180 x 450 x 600 mm

Farben: .631 .627 .628

Available from 2nd Quarter 2019

Verfügbar ab 2. Quartal 2019

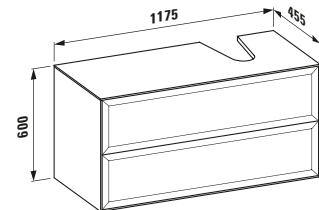

406088

Drawer element 1200, 2 drawers, cut-out right

Schubladenelement 1200, 2 Schubladen, Ausschnitt rechts

1180 x 450 x 600 mm

Farben: .631 .627 .628

Available from 2nd Quarter 2019

Verfügbar ab 2. Quartal 2019

THE NEW CLASSIC

813853



Vanity washbasin

Möbelwaschtisch

600 x 480 x 75 mm

Farben: .000 .400 .757

Optionen: .104 .109 .108 .136 .158

Available from 2nd Quarter 2019

Verfügbar ab 2. Quartal 2019

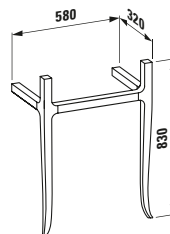
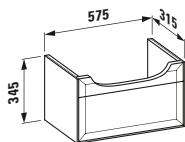
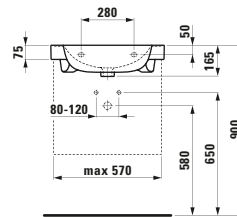
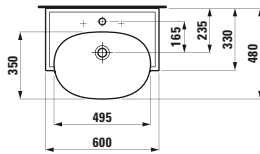

406031

Vanity unit, 1 drawer,
matches vanity washbasin 813853

*Waschtischunterbau, 1 Schublade,
passend zu Möbelwaschtisch 813853*

580 x 320 x 340 mm

Farben: .631 .627 .628

Available from 2nd Quarter 2019

Verfügbar ab 2. Quartal 2019

406071

Washbasin frame

Waschtischgestell

580 x 320 x 820 mm

Farben: .629

Available from 3rd Quarter 2019

Verfügbar ab 3. Quartal 2019

813855



Vanity washbasin

Möbelwaschtisch

800 x 480 x 75 mm

Farben: .000 .400 .757

Optionen: .104 .109 .108 .136 .158

Available from 2nd Quarter 2019

Verfügbar ab 2. Quartal 2019

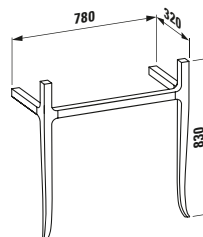
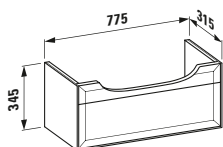
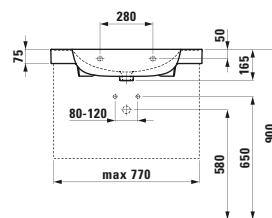
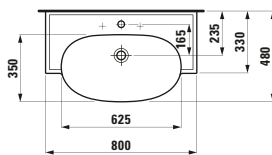

406041

Vanity unit, 1 drawer,
matches vanity washbasin 813855

*Waschtischunterbau, 1 Schublade,
passend zu Möbelwaschtisch 813855*

780 x 320 x 340 mm

Farben: .631 .627 .628

Available from 2nd Quarter 2019

Verfügbar ab 2. Quartal 2019

406072

Washbasin frame

Waschtischgestell

780 x 320 x 820 mm

Farben: .629

Available from 3rd Quarter 2019

Verfügbar ab 3. Quartal 2019

813858



Vanity washbasin

Möbelwaschtisch

1200 x 480 x 75 mm

Farben: .000 .400 .757

Optionen: .104 .107 .108 .109 .136 .115 .158

Available from 3rd Quarter 2019

Verfügbar ab 3. Quartal 2019

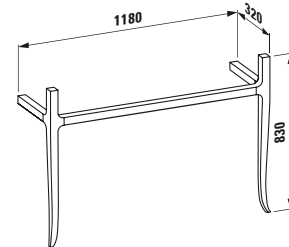
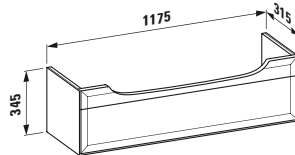
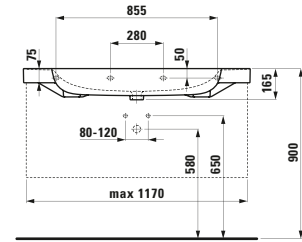
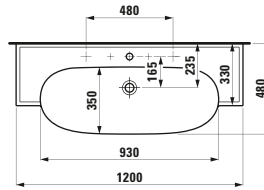

406051

Vanity unit, 1 drawer,
matches vanity washbasin 813858

*Waschtischunterbau, 1 Schublade,
passend zu Möbelwaschtisch 813858*

1180 x 320 x 340 mm

Farben: .631 .627 .628

Available from 3rd Quarter 2019

Verfügbar ab 3. Quartal 2019

406073

Washbasin frame

Waschtischgestell

1180 x 320 x 820 mm

Farben: .629

Available from 3rd Quarter 2019

Verfügbar ab 3. Quartal 2019

812852



Bowl washbasin, oval

Waschtisch-Schale, oval

550 x 380 x 145 mm

Farben: .000 .400 .757

Optionen: .112

Available from 2nd Quarter 2019

Verfügbar ab 2. Quartal 2019

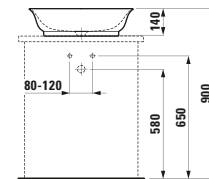
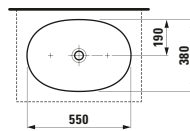

812853



Bowl washbasin with overflow channel, oval

Waschtisch-Schale mit Überlaufkanal, oval

550 x 380 x 145 mm

Farben: .000 .400 .757

Optionen: .109

Available from 2nd Quarter 2019

Verfügbar ab 2. Quartal 2019

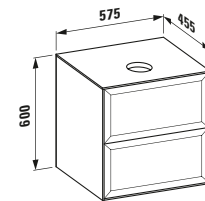
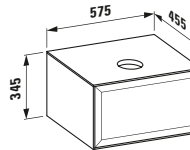

406001

Drawer element 600, 1 drawer,
with centre cut-out

*Schubladenelement 600, 1 Schublade,
mit Ausschnitt Mitte*

580 x 450 x 350 mm

Farben: .631 .627 .628

Available from 2nd Quarter 2019

Verfügbar ab 2. Quartal 2019

406002

Drawer element 600, 2 drawer,
with centre cut-out

*Schubladenelement 600, 2 Schublade,
mit Ausschnitt Mitte*

580 x 450 x 600 mm

Farben: .631 .627 .628

Available from 2nd Quarter 2019

Verfügbar ab 2. Quartal 2019

THE NEW CLASSIC

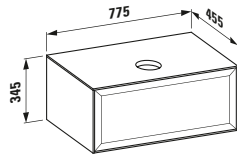

406011

Drawer element 800, 1 drawer, with centre cut-out

Schubladenelement 800, 1 Schublade, mit Ausschnitt Mitte

780 x 450 x 350 mm

Farben: .631 .627 .628

Available from 2nd Quarter 2019

Verfügbar ab 2. Quartal 2019

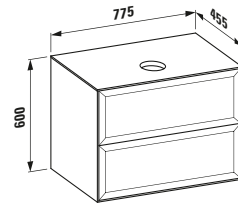

406012

Drawer element 800, 2 drawer, with centre cut-out

Schubladenelement 800, 2 Schublade, mit Ausschnitt Mitte

780 x 450 x 600 mm

Farben: .631 .627 .628

Available from 2nd Quarter 2019

Verfügbar ab 2. Quartal 2019

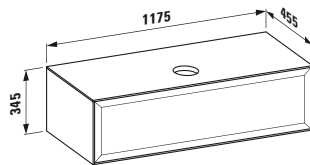

406021

Drawer element 1200, 1 drawer, with centre cut-out

Schubladenelement 1200, 1 Schublade, mit Ausschnitt Mitte

1180 x 450 x 350 mm

Farben: .631 .627 .628

Available from 2nd Quarter 2019

Verfügbar ab 2. Quartal 2019

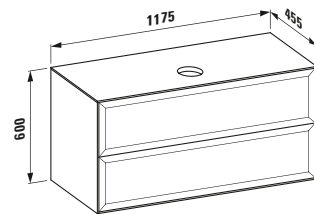

406022

Drawer element 1200, 2 drawer, with centre cut-out

Schubladenelement 1200, 2 Schublade, mit Ausschnitt Mitte

1180 x 450 x 600 mm

Farben: .631 .627 .628

Available from 2nd Quarter 2019

Verfügbar ab 2. Quartal 2019

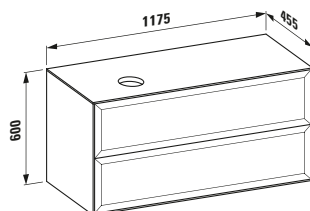

406083

Drawer element 1200, 2 drawers, cut-out left

Schubladenelement 1200, 2 Schubladen, Ausschnitt links

1180 x 450 x 350 mm

Farben: .631 .627 .628

Available from 2nd Quarter 2019

Verfügbar ab 2. Quartal 2019

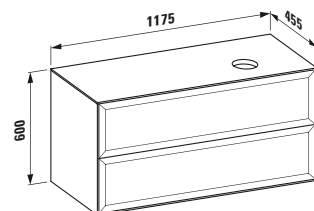

406084

Drawer element 1200, 2 drawers, cut-out right

Schubladenelement 1200, 2 Schubladen, Ausschnitt rechts

1180 x 450 x 350 mm

Farben: .631 .627 .628

Available from 2nd Quarter 2019

Verfügbar ab 2. Quartal 2019

THE NEW CLASSIC

820851

Wall-hung WC, washdown, rimless
Wand-WC, Tiefspüler, spülrandlos
 530 x 370 x 430 mm

Farben: .000 .400 .757

Optionen: .000

Available from 2nd Quarter 2019

Verfügbar ab 2. Quartal 2019

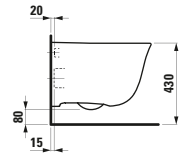
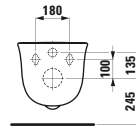
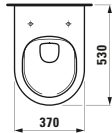

830851

Wall-hung bidet
Wandbidet
 530 x 370 x 430 mm

Farben: .000 .400 .757

Optionen: .302

Available from 2nd Quarter 2019

Verfügbar ab 2. Quartal 2019

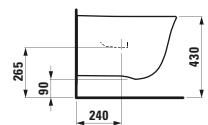
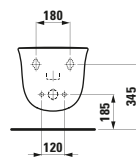
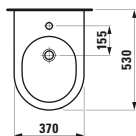

823851

Floorstanding WC, washdown, rimless,
 outlet horizontal or vertical

*Stand-WC, Tiefspüler, spülrandlos,
 Abgang waagrecht oder senkrecht*

560 x 370 x 430 mm

Farben: .000 .400 .757

Optionen: .000

Available from 4th Quarter 2019

Verfügbar ab 4. Quartal 2019

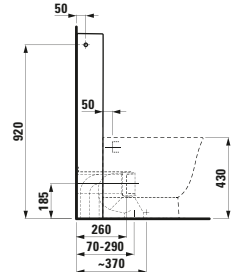
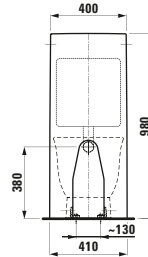
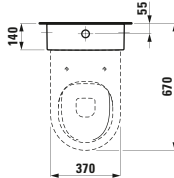

829660 UNIVERSAL

Floorstanding cistern, two-part,
 side water inlet (left or right)

*Stand-Spülkasten, zweiteilig,
 Wasseranschluss seitlich
 (links oder rechts)*

400 x 140 x 980 mm

Farben: .000 .757

Optionen: .882

Available from 3rd Quarter 2019

Verfügbar ab 3. Quartal 2019

829661 UNIVERSAL

Floorstanding cistern, two-part,
 rear water inlet (left top)

*Stand-Spülkasten, zweiteilig,
 Wasseranschluss hinten
 (links oben)*

400 x 140 x 980 mm

Farben: .000 .757

Optionen: .881

Available from 3rd Quarter 2019

Verfügbar ab 3. Quartal 2019

829663 UNIVERSAL

Floorstanding cistern,
 two-part, water inlet on the left
 side or at the bottom

*Stand-Spülkasten, zweiteilig,
 Wasseranschluss seitlich
 links oder am Boden*

400 x 140 x 980 mm

Farben: .000 .757

Optionen: .883 .845

Available from 3rd Quarter 2019

Verfügbar ab 3. Quartal 2019

829664 UNIVERSAL

Floorstanding cistern,
 two-part, water inlet on the
 right side or at the bottom

*Stand-Spülkasten, zweiteilig,
 Wasseranschluss seitlich
 rechts oder am Boden*

400 x 140 x 980 mm

Farben: .000 .757

Optionen: .884

Available from 3rd Quarter 2019

Verfügbar ab 3. Quartal 2019

THE NEW CLASSIC

824858

Floorstanding WC, close-coupled, washdown, rimless, outlet horizontal or vertical

Stand-WC für aufgesetzten Spülkasten, Tiefspüler, spülrandlos, Abgang waagrecht oder senkrecht

700 x 370 x 430 mm

Farben: .000 .400 .757

Optionen: .000 .231 .251

Available from 4th Quarter 2019

Verfügbar ab 4. Quartal 2019

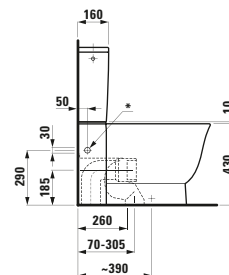
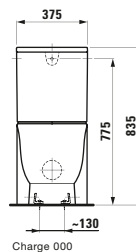
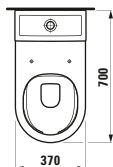

828851

Cistern, rear water inlet (center)

Spülkasten, Wasseranschluss hinten mittig

365 x 150 x 395 mm

Farben: .000 .757

Optionen: .871

Available from 4th Quarter 2019

Verfügbar ab 4. Quartal 2019

828852

Cistern, side water inlet (left or right)

Spülkasten, Wasseranschluss seitlich (links oder rechts)

365 x 150 x 395 mm

Farben: .000 .757

Optionen: .872

Available from 4th Quarter 2019

Verfügbar ab 4. Quartal 2019

828853

Cistern, water inlet at bottom left

Spülkasten, Wasseranschluss unten links

365 x 150 x 395 mm

Farben: .000 .757

Optionen: .873 .843

Available from 4th Quarter 2019

Verfügbar ab 4. Quartal 2019

828855

Cistern, water inlet at bottom right

Spülkasten, Wasseranschluss unten rechts

365 x 150 x 395 mm

Farben: .000 .757

Optionen: .873

Available from 4th Quarter 2019

Verfügbar ab 4. Quartal 2019

406061

Tall cabinet, 1 door, left hinged, with 4 wooden shelves

Hochschrank, 1 Tür, Scharnier links, mit 4 Holzfachböden

330 x 330 x 1600 mm

Farben: .631 .627 .628

Available from 2nd Quarter 2019

Verfügbar ab 2. Quartal 2019

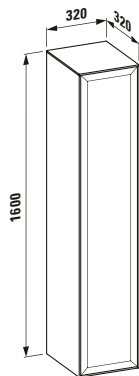

406062

Tall cabinet, 1 door, right hinged, with 4 wooden shelves

Hochschrank, 1 Tür, Scharnier rechts, mit 4 Holzfachböden

330 x 330 x 1600 mm

Farben: .631 .627 .628

Available from 2nd Quarter 2019

Verfügbar ab 2. Quartal 2019

406074

Set of adjustable feet

Stellfuß-Set

85 x 85 x 165 mm

Farben: .631 .170

Available from 3rd Quarter 2019

Verfügbar ab 3. Quartal 2019

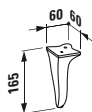

220852

Freestanding bathtub,
made of solid surface material Sentec

*Freistehende Badewanne,
aus Mineralgusswerkstoff Sentec*

1900 x 900 x 580 mm

Farben: .000

Optionen: .000

Available from 2nd Quarter 2019

Verfügbar ab 2. Quartal 2019

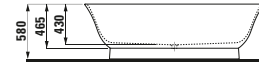
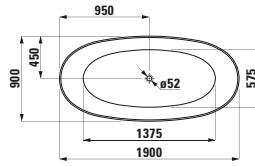

406070

Ceramic Mirror with LED ambient light,
for room switch, 4000K

*Keramischer Spiegel mit LED Ambientlicht,
für Lichtschalter, 4000K*

500 x 80 x 700 mm

Farben: .000 .757

Available from 3rd Quarter 2019

Verfügbar ab 3. Quartal 2019

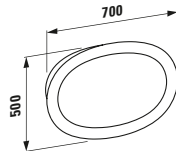

877851

Ceramic shelf

Keramische Ablage

420 x 160 mm

Farben: .000 .757

Optionen: .000*

Available from 4th Quarter 2019

*Screwed (screws included) or glued
(adhesive included)

Verfügbar ab 4. Quartal 2019

**Montage geschraubt (Schrauben inklusive)
oder geklebt (Klebstoff inklusive)*



873852

Ceramic toilet brush holder, incl. toilet brush

Keramische WC-Bürstengarnitur, inkl. Klosettbürste

Farben: .000 .757

Optionen: .000*

Available from 4th Quarter 2019

*Screwed (screws included) or glued
(adhesive included)

Verfügbar ab 4. Quartal 2019

**Montage geschraubt (Schrauben inklusive)
oder geklebt (Klebstoff inklusive)*



873854

Ceramic tooth brush holder, incl. mounting material

Keramischer Zahnbürstenhalter inkl. Befestigungsmaterial

Farben: .000 .757

Optionen: .000*

Available from 4th Quarter 2019

*Screwed (screws included) or glued
(adhesive included)

Verfügbar ab 4. Quartal 2019

**Montage geschraubt (Schrauben inklusive)
oder geklebt (Klebstoff inklusive)*



873856

Ceramic soap dish

Keramische Seifenschale

140 x 115 x 35 mm

Farben: .000 .757

Optionen: .000

Available from 4th Quarter 2019

Verfügbar ab 4. Quartal 2019



THE NEW CLASSIC

3118510041111

Single lever basin mixer, projection 105 mm, fixed spout, with pop-up waste

Einhebel-Waschtischmischer, Ausladung 105 mm, Festauslauf, mit Ablaufventil

Farben: .004

Available from 4th Quarter 2019

Verfügbar ab 4. Quartal 2019

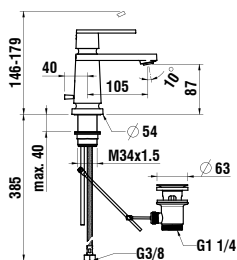

3118510041101

Single lever basin mixer, projection 105 mm, fixed spout, without pop-up waste

Einhebel-Waschtischmischer, Ausladung 105 mm, Festauslauf, ohne Ablaufventil

Farben: .004

Available from 4th Quarter 2019

Verfügbar ab 4. Quartal 2019

3118510041211

Single lever basin mixer, projection 130 mm, fixed spout, with pop-up waste

Einhebel-Waschtischmischer, Ausladung 130 mm, Festauslauf, mit Ablaufventil

Farben: .004

Available from 4th Quarter 2019

Verfügbar ab 4. Quartal 2019

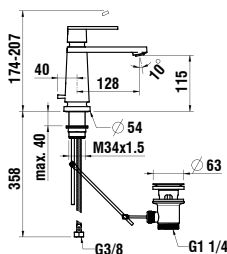

3118510041201

Single lever basin mixer, projection 130 mm, fixed spout, without pop-up waste

Einhebel-Waschtischmischer, Ausladung 130 mm, Festauslauf, ohne Ablaufventil

Farben: .004

Available from 4th Quarter 2019

Verfügbar ab 4. Quartal 2019

3118580041201

Column single lever basin mixer, projection 175 mm, fixed spout, without pop-up waste

Standsäulen-Einhebel-Waschtischmischer, Ausladung 175 mm, Festauslauf, ohne Ablaufventil

Farben: .004

Available from 4th Quarter 2019

Verfügbar ab 4. Quartal 2019

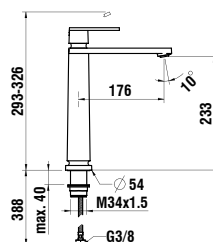

3128530041211

3-hole basin mixer, projection 130 mm, fixed spout, with pop-up waste lever, with pop-up waste

3-Loch Waschtischmischer, Ausladung 130 mm, Festauslauf, mit Ablaufventilhebel, mit Ablaufventil

Farben: .004

Available from 4th Quarter 2019

Verfügbar ab 4. Quartal 2019

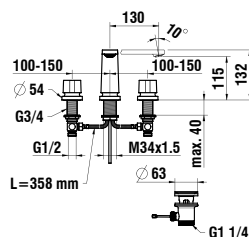

3128530041201

3-hole basin mixer, projection 130 mm, fixed spout, without pop-up waste valve

3-Loch Waschtischmischer, Ausladung 130 mm, Festauslauf, ohne Ablaufventil

Farben: .004

Available from 4th Quarter 2019

Verfügbar ab 4. Quartal 2019

3118560041201

Concealed single lever basin mixer for Simibox
2-Point, fixed spout, projection 180 mm

*Einhebel-Unterputz-Waschtischmischer für Simibox
2-Point, Festauslauf, Ausladung 180 mm*

Farben: .004

Available from 4th Quarter 2019

Verfügbar ab 4. Quartal 2019

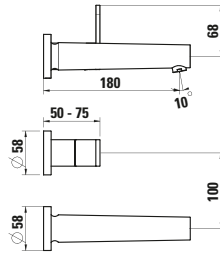

3128560041201

Concealed twin handled basin mixer,
projection 180 mm

*2-Griff-Unterputz-Waschtischmischer,
Ausladung 180 mm*

Farben: .004

Available from 4th Quarter 2019

Verfügbar ab 4. Quartal 2019

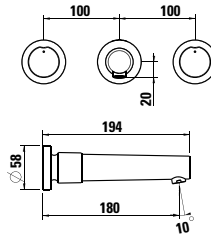

3418510041111

Single lever bidet mixer, projection 110 mm,
fixed spout, with pop-up waste

*Einhebel-Bidetmischer, Ausladung 110 mm,
Festauslauf, mit Ablaufventil*

Farben: .004

Available from 4th Quarter 2019

Verfügbar ab 4. Quartal 2019

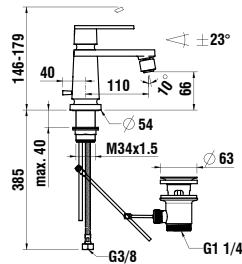

3318570041411

Wall-mounted single lever shower mixer,
with one outlet, with accessories

*Aufputz-Einhebel-Duschenmischer,
für einen Verbraucher, mit Zubehör*

Farben: .004

Available from 4th Quarter 2019

Verfügbar ab 4. Quartal 2019

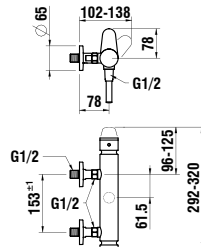

3318570044001

Wall-mounted single lever shower mixer,
with one outlet, without accessories

*Aufputz-Einhebel-Duschenmischer,
für einen Verbraucher, ohne Zubehör*

Farben: .004

Available from 4th Quarter 2019

Verfügbar ab 4. Quartal 2019

THE NEW CLASSIC

3218570041411

Wall-mounted single lever bath mixer,
with 2-way diverter, with accessories

*Aufputz-Einhebel-Bademischer,
mit Umsteller für 2 Verbraucher, mit Zubehör*

Farben: .004

Available from 4th Quarter 2019

Verfügbar ab 4. Quartal 2019

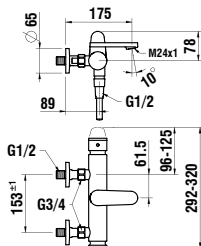

3218570044001

Wall-mounted single lever bath mixer,
with 2-way diverter, without accessories

*Aufputz-Einhebel-Bademischer,
mit Umsteller für 2 Verbraucher, ohne Zubehör*

Farben: .004

Available from 4th Quarter 2019

Verfügbar ab 4. Quartal 2019

3318560040001

Set for concealed single lever shower mixer,
with one outlet

*Fertigmontageset für Unterputz-Einhebel-
Duschenmischer, für einen Verbraucher*

Farben: .004

Available from 4th Quarter 2019

Verfügbar ab 4. Quartal 2019

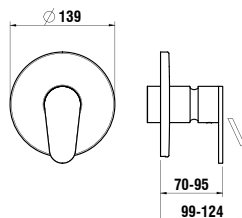

3799840040501

3218560040001

Set for concealed single lever bath mixer,
with 2-way diverter

*Fertigmontageset für Unterputz-Einhebel-
Bademischer, mit Umsteller für 2 Verbraucher*

Farben: .004

Available from 4th Quarter 2019

Verfügbar ab 4. Quartal 2019

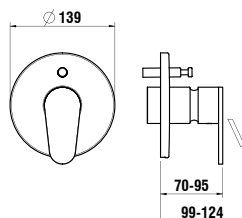

3218560040101

Set for concealed single lever bath mixer,
with 2-way diverter, with integrated vacuum breaker

*Fertigmontageset für Unterputz-Einhebel-
Bademischer, mit Umsteller für 2 Verbraucher,
mit integriertem Rohrunterbrecher*

Farben: .004

Available from 4th Quarter 2019

Verfügbar ab 4. Quartal 2019

3799840040501

3718500040601

Wall-mounted spout, fixed spout, projection 180 mm

Wanneneinlauf, Festauslauf, Ausladung 180 mm

Farben: .004

Available from 4th Quarter 2019

Verfügbar ab 4. Quartal 2019

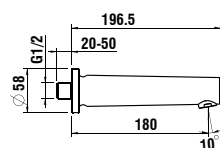

3638500041521

Shower hose connector with integrated shower holder, with vacuum breaker, all-metal

Anschlussbogen mit integriertem Brausehalter, mit Rohrunterbrecher, Vollmetall

Farben: .004

Available from 4th Quarter 2019

Verfügbar ab 4. Quartal 2019

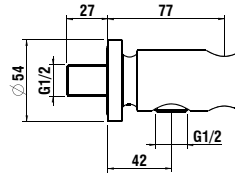

3638500041511

Shower hose connector, with check-valve, all-metal

Anschlussbogen, mit Rückflussverhinderer, Vollmetall

Farben: .004

Available from 4th Quarter 2019

Verfügbar ab 4. Quartal 2019

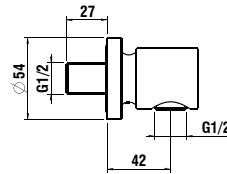

3698500042011

Fixed shower holder, all-metal

Fester Brausehalter, Vollmetall

Farben: .004

Available from 4th Quarter 2019

Verfügbar ab 4. Quartal 2019

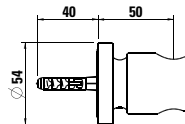

DUSCH-WC'S CLEANET

820601 NAVIA

Shower Toilet, wall-hung, rimless, washdown, incl. seat and cover removable with lowering system

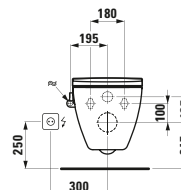
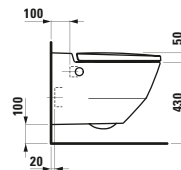
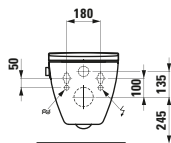
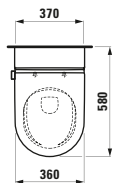

Technical details:

- Rated voltage 220 to 240 V, 50/60 Hz
- Power consumption in use max. 1150 W
- Protection rating IPX4
- Protection class I
- Direct connection by NYM cable possible
- Operating temperature range +5 to +40 °C
- Water flow pressure range 0.1 to 1 MPa
- Flow rate max. 3.5L/min
- Shower 7 pressure levels
- Shower 7 temperature levels via app
- Drinking water standards EN 1717
- Compatible with Laufen LIS and commercial installation systems, see compatibility list

Dusch-WC spülrandlos, wandhängend, Tiefspüler, inkl. WC-Sitz mit Deckel, abnehmbar, mit Absenk-automatik

Technische Angaben

- Nennspannung 220 bis 240 V, 50/60 Hz
- Leistungsaufnahme Betrieb max. 1150W
- Schutzart IPX4
- Schutzklasse I
- Direktanschluss über NYM-Kabel möglich
- Betriebstemperaturbereich +5 bis +40°C
- Fließdruckbereich Wasser 0,1 bis 1 MPa
- Durchfluss max. 3.5 l/min
- Dusche 7 Druckstufen
- Dusche 7 Temperaturstufen über App
- Trinkwassernormen EN 1717
- Passend auf Laufen LIS und handelsübliche Installationssysteme, siehe Kompatibilitätsliste

580 x 370 x 380 (430) mm

Farben: .400 .757

Optionen: .000* .717**

Available from 2nd Quarter 2019

* Adapterplatte 894690 only available for this version

** with lateral opening for water supply

Verfügbar ab 2. Quartal 2019

* Adapterplatte 894690 nur mit dieser Version kombinierbar

** mit seitlicher Öffnung für externen

Wasseranschluss 19,5 cm außerhalb der Mitte

Version .717 with lateral opening for water supply

Ausführung .717 mit seitlicher Öffnung für externen Wasseranschluss

894690

Adapter plate for shower toilet installation with connections above 9 cm outside of centre

Adapterplatte zur Installation des Dusch-WC's mit Anschlüssen über 9 cm außerhalb der Mitte

450 x 450 x 25 mm

Farben: .000*

Optionen: .000

* color white matt

* Farbe weiß matt

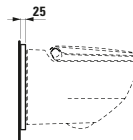
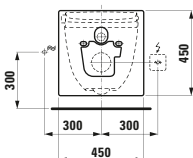

DUSCH-WC'S CLEANET

894661 LIS

Installation system LIS CW2 with cistern for wall-hung WC and shower toilet, dual flush 6/3L (adjustable to 4.5/3L)



CW2 Installationssystem LIS mit Spülkasten für Wand-WC und Dusch-WC, Zwei-Mengen-Spülung 6/3L (umstellbar auf 4.5/3L)

500 x 140-195 x 1120-1320 mm

Farben: .000

Optionen: .000

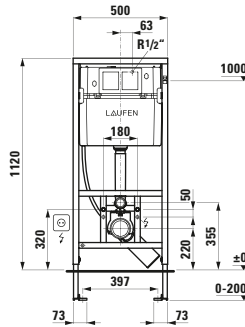

894666 LIS

Installation system LIS CW2 with cistern for wall-hung WC and shower toilet, dual flush 4.5/3L (adjustable to 6/3L)



CW2 Installationssystem LIS mit Spülkasten für Wand-WC und Dusch-WC, Zwei-Mengen-Spülung 4.5/3L (umstellbar auf 6/3L)

500 x 140-195 x 1120-1320 mm

Farben: .000

Optionen: .000

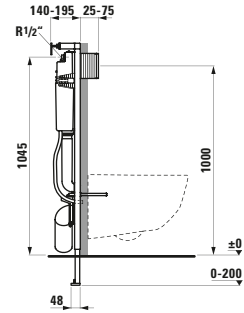

SONAR

815341

Small washbasin, incl. ceramic waste cover

Handwaschbecken,
inkl. Keramikabdeckung für Ablaufventil

410 x 420 x 140 mm

Farben: .000 .400 .757

Optionen: .104 .109

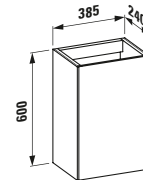
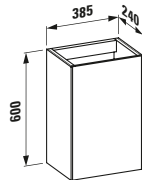
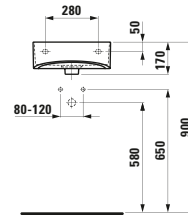
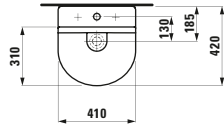

405481

Vanity unit, 1 door, left hinged

Waschtischunterbau, 1 Tür, Scharnier links

390 x 240 x 600 mm

Farben: .040 .041 .042

Available from 2nd Quarter 2019

Verfügbar ab 2. Quartal 2019

405482

Vanity unit, 1 door, right hinged

Waschtischunterbau, 1 Tür, Scharnier rechts

390 x 240 x 600 mm

Farben: .040 .041 .042

Available from 2nd Quarter 2019

Verfügbar ab 2. Quartal 2019

810342

Washbasin

Waschtisch

600 x 420 x 140 mm

Farben: .000 .400 .757

Optionen: .104 .108 .109 .136

Available from 2nd Quarter 2019

Verfügbar ab 2. Quartal 2019

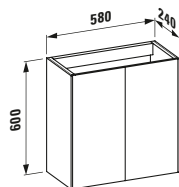
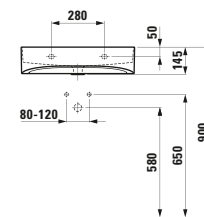
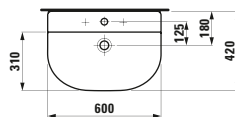

405483

Vanity unit, 2 doors

Waschtischunterbau, 2 Türen

580 x 240 x 600 mm

Farben: .040 .041 .042

Available from 2nd Quarter 2019

Verfügbar ab 2. Quartal 2019

816342

Washbasin, undersurface ground

Aufsatz-Waschtisch

600 x 420 x 140 mm

Farben: .000 .400 .757

Optionen: .104 .108 .109 .136

Available from 2nd Quarter 2019

Verfügbar ab 2. Quartal 2019

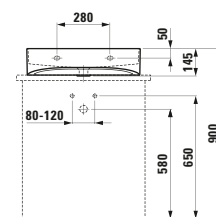
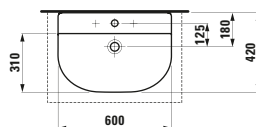

810347



Washbasin

Waschtisch

1000 x 420 x 140 mm

Farben: .000 .400 .757

Optionen: .104 .107 .108 .109 .136

Available from 3rd Quarter 2019

Verfügbar ab 3. Quartal 2019

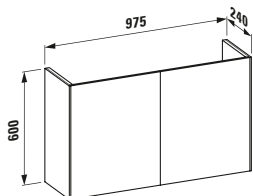
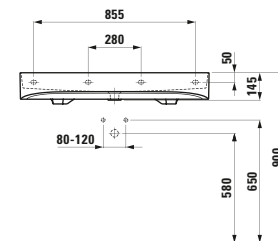
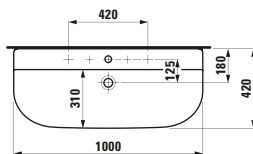

405484

Vanity unit, 2 doors

Waschtischunterbau, 2 Türen

980 x 240 x 600 mm

Farben: .040 .041 .042

Available from 3rd Quarter 2019

Verfügbar ab 3. Quartal 2019

816347



Washbasin, undersurface ground

Aufsatz-Waschtisch

1000 x 420 x 140 mm

Farben: .000 .400 .757

Optionen: .104 .107 .108 .109 .136

Available from 3rd Quarter 2019

Verfügbar ab 3. Quartal 2019

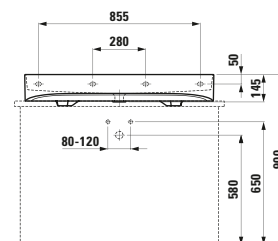
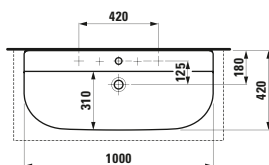

820341

Wall-hung WC, washdown, rimless

Wand-WC, Tiefspüler, spülrandlos

530 x 370 x 340 (430) mm

Farben: .000 .400 .757

Optionen: .000

Available from 4th Quarter 2019

Verfügbar ab 4. Quartal 2019

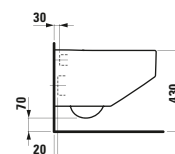
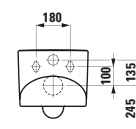
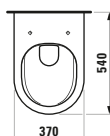

893341

WC seat and cover, removable, with lowering system

Sitz mit Deckel, abnehmbar, mit Absenkautomatik

Farben: .000 .757

Optionen: .000

Available from 4th Quarter 2019

Verfügbar ab 4. Quartal 2019

830341

Wall-hung bidet

Wandbidet

530 x 370 x 340 (430) mm

Farben: .000 .400 .757

Optionen: .302

Available from 4th Quarter 2019

Verfügbar ab 4. Quartal 2019

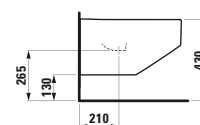
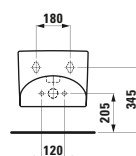
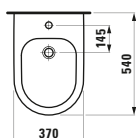

SONAR

823341

Floorstanding WC, washdown, rimless, outlet horizontal or vertical

Stand-WC, Tiefspüler, spülrandlos, Abgang waagrecht/senkrecht

530 x 370 x 430 mm

Farben: .000 .400 .757

Optionen: .000

Available from 4th Quarter 2019

Verfügbar ab 4. Quartal 2019

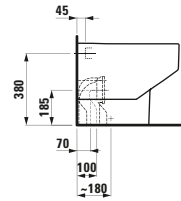
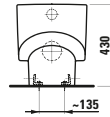
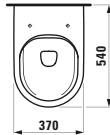

829660 UNIVERSAL

Floorstanding cistern, two-part, side water inlet (left or right)

Stand-Spülkasten, zweiteilig, Wasseranschluss seitlich (links oder rechts)

400 x 140 x 980 mm

Farben: .000 .757

Optionen: .882

Available from 3rd Quarter 2019

Verfügbar ab 3. Quartal 2019

829661 UNIVERSAL

Floorstanding cistern, two-part, rear water inlet (left top)

Stand-Spülkasten, zweiteilig, Wasseranschluss hinten (links oben)

400 x 140 x 980 mm

Farben: .000 .757

Optionen: .881

Available from 3rd Quarter 2019

Verfügbar ab 3. Quartal 2019

829663 UNIVERSAL

Floorstanding cistern, two-part, water inlet on the left side or at the bottom

Stand-Spülkasten, zweiteilig, Wasseranschluss seitlich links oder am Boden

400 x 140 x 980 mm

Farben: .000 .757

Optionen: .883 .845

Available from 3rd Quarter 2019

Verfügbar ab 3. Quartal 2019

829664 UNIVERSAL

Floorstanding cistern, two-part, water inlet on the right side or at the bottom

Stand-Spülkasten, zweiteilig, Wasseranschluss seitlich rechts oder am Boden

400 x 140 x 980 mm

Farben: .000 .757

Optionen: .884

Available from 3rd Quarter 2019

Verfügbar ab 3. Quartal 2019

893341

WC seat and cover, removable, with lowering system

Sitz mit Deckel, abnehmbar, mit Absenkautomatik

Farben: .000 .757

Optionen: .000

Available from 4th Quarter 2019

Verfügbar ab 4. Quartal 2019

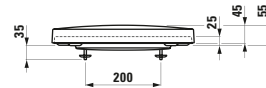
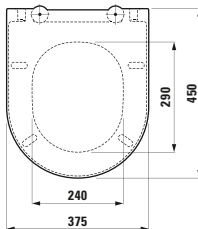

894340

Brackets for wall mounting of Sonar washbasin bowls

Winkelträger für die Wandmontage der Sonar-Waschtischschalen

Optionen: .000

Available from 4th Quarter 2019

Verfügbar ab 4. Quartal 2019

405401

Drawer element, 1 drawer, matching bowl washbasins 812340, 812341, 812342, 812343, centre cut-out

Schubladenelement, 1 Schublade, passend zu Waschtisch-Schalen 812340, 812341, 812342, 812343, Ausschnitt Mitte

580 x 450 x 340 mm

Farben: .040 .041 .042 .140 .141 .142

Available from 2nd Quarter 2019

Verfügbar ab 2. Quartal 2019

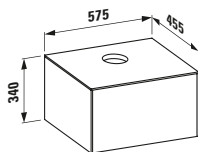

405411

Drawer element, 1 drawer, matching bowl washbasins 812340, 812341, 812342, 812343, centre cut-out

Schubladenelement, 1 Schublade, passend zu Waschtisch-Schalen 812340, 812341, 812342, 812343, Ausschnitt Mitte

780 x 450 x 340 mm

Farben: .040 .041 .042 .140 .141 .142

Available from 2nd Quarter 2019

Verfügbar ab 2. Quartal 2019

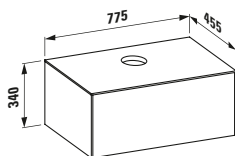

405421

Drawer element, 1 drawer, matching bowl washbasins 812340, 812341, 812342, 812343, centre cut-out

Schubladenelement, 1 Schublade, passend zu Waschtisch-Schalen 812340, 812341, 812342, 812343, Ausschnitt Mitte

1180 x 450 x 340 mm

Farben: .040 .041 .042 .140 .141 .142

Available from 2nd Quarter 2019

Verfügbar ab 2. Quartal 2019

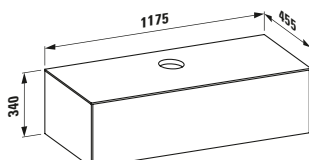

405422

Drawer element, 1 drawer, matching bowl washbasins 812340, 812341, 812342, 812343, cut-out left / right

Schubladenelement, 1 Schublade, passend zu Waschtisch-Schalen 812340, 812341, 812342, 812343, Ausschnitt links / rechts

1180 x 450 x 340 mm

Farben: .040 .041 .042 .140 .141 .142

Available from 2nd Quarter 2019

Verfügbar ab 2. Quartal 2019

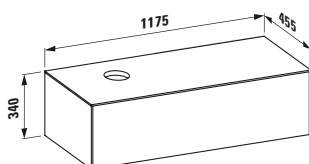

405423

Drawer element, 1 drawer, matching bowl washbasins 812340, 812341, 812342, 812343, cut-out left / right

Schubladenelement, 1 Schublade, passend zu Waschtisch-Schalen 812340, 812341, 812342, 812343, Ausschnitt links / rechts

1180 x 450 x 340 mm

Farben: .040 .041 .042 .140 .141 .142

Available from 2nd Quarter 2019

Verfügbar ab 2. Quartal 2019

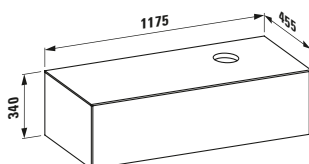

405424

Drawer element, 1 drawer, matching bowl washbasins 812340, 812341, 812342, 812343, cut-outs left and right

Schubladenelement, 1 Schublade, passend zu Waschtisch-Schalen 812340, 812341, 812342, 812343, Ausschnitt links und rechts

1180 x 450 x 340 mm

Farben: .040 .041 .042 .140 .141 .142

Available from 2nd Quarter 2019

Verfügbar ab 2. Quartal 2019

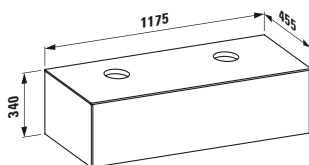

405405

Drawer element, 1 drawer, matching bowl washbasins 812340, 812341, 812342, 812343, centre cut-out incl. drilled tap hole

Schubladenelement, 1 Schublade, passend zu Waschtisch-Schalen 812340, 812341, 812342, 812343, Ausschnitt Mitte inkl. gebohrtes Hahnloch

580 x 450 x 340 mm

Farben: .140 .141 .142

Available from 2nd Quarter 2019

Verfügbar ab 2. Quartal 2019

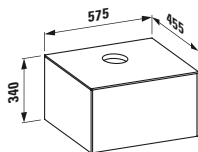

405415

Drawer element, 1 drawer, matching bowl washbasins 812340, 812341, 812342, 812343, centre cut-out incl. drilled tap hole

Schubladenelement, 1 Schublade, passend zu Waschtisch-Schalen 812340, 812341, 812342, 812343, Ausschnitt Mitte inkl. gebohrtes Hahnloch

780 x 450 x 340 mm

Farben: .140 .141 .142

Available from 2nd Quarter 2019

Verfügbar ab 2. Quartal 2019

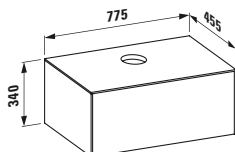

405425

Drawer element, 1 drawer, matching bowl washbasins 812340, 812341, 812342, 812343, centre cut-out incl. drilled tap hole

Schubladenelement, 1 Schublade, passend zu Waschtisch-Schalen 812340, 812341, 812342, 812343, Ausschnitt Mitte inkl. gebohrtes Hahnloch

1180 x 450 x 340 mm

Farben: .140 .141 .142

Available from 2nd Quarter 2019

Verfügbar ab 2. Quartal 2019

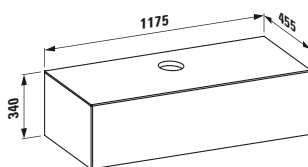

405426

Drawer element, 1 drawer, matching bowl washbasins 812340, 812341, 812342, 812343, cut-out left / right, incl. drilled tap hole

Schubladenelement, 1 Schublade, passend zu Waschtisch-Schalen 812340, 812341, 812342, 812343, Ausschnitt links / rechts, inkl. gebohrtes Hahnloch

1180 x 450 x 340 mm

Farben: .140 .141 .142

Available from 2nd Quarter 2019

Verfügbar ab 2. Quartal 2019

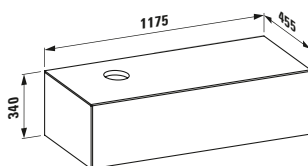

405427

Drawer element, 1 drawer, matching bowl washbasins 812340, 812341, 812342, 812343, cut-out left / right, incl. drilled tap hole

Schubladenelement, 1 Schublade, passend zu Waschtisch-Schalen 812340, 812341, 812342, 812343, Ausschnitt links / rechts, inkl. gebohrtes Hahnloch

1180 x 450 x 340 mm

Farben: .140 .141 .142

Available from 2nd Quarter 2019

Verfügbar ab 2. Quartal 2019

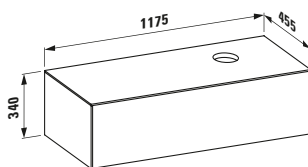

405428

Drawer element, 1 drawer, matching bowl washbasins 812340, 812341, 812342, 812343, cut-outs left and right incl. drilled tap holes

Schubladenelement, 1 Schublade, passend zu Waschtisch-Schalen 812340, 812341, 812342, 812343, Ausschnitt links und rechts inkl. gebohrte Hahnlöcher

1180 x 450 x 340 mm

Farben: .140 .141 .142

Available from 2nd Quarter 2019

Verfügbar ab 2. Quartal 2019

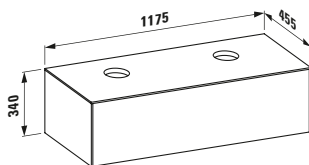

405431

Drawer element, 1 drawer, matching small washbasin 816341, centre cut-out

Schubladenelement, 1 Schublade, passend zu Aufsatz-Handwaschbecken 816341, Ausschnitt Mitte

580 x 450 x 340 mm

Farben: .040 .041 .042 .140 .141 .142

Available from 2nd Quarter 2019

Verfügbar ab 2. Quartal 2019

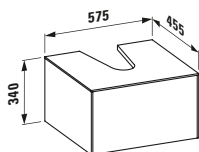

405441

Drawer element, 1 drawer, matching washbasins 816341, 816342, centre cut-out

Schubladenelement, 1 Schublade, passend zu Aufsatz-Waschtischen 816341, 816342, Ausschnitt Mitte

780 x 450 x 340 mm

Farben: .040 .041 .042 .140 .141 .142

Available from 2nd Quarter 2019

Verfügbar ab 2. Quartal 2019

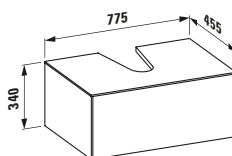

405451

Drawer element, 1 drawer, matching washbasins 816341, 816342, centre cut-out

Schubladenelement, 1 Schublade, passend zu Aufsatz-Waschtischen 816341, 816342, Ausschnitt Mitte

1180 x 450 x 340 mm

Farben: .040 .041 .042 .140 .141 .142

Available from 2nd Quarter 2019

Verfügbar ab 2. Quartal 2019

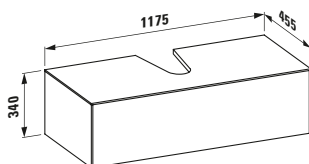

405452

Drawer element, 1 drawer, matching washbasins 816341, 816342, cut-out left / right

Schubladenelement, 1 Schublade, passend zu Aufsatz-Waschtischen 816341, 816342, Ausschnitt links / rechts

1180 x 450 x 340 mm

Farben: .040 .041 .042 .140 .141 .142

Available from 2nd Quarter 2019

Verfügbar ab 2. Quartal 2019

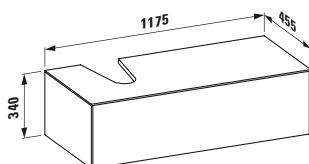

405453

Drawer element, 1 drawer, matching washbasins 816341, 816342, cut-out left / right

Schubladenelement, 1 Schublade, passend zu Aufsatz-Waschtischen 816341, 816342, Ausschnitt links / rechts

1180 x 450 x 340 mm

Farben: .040 .041 .042 .140 .141 .142

Available from 2nd Quarter 2019

Verfügbar ab 2. Quartal 2019

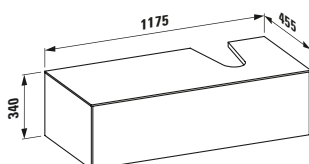

SONAR

405454

Drawer element, 1 drawer, matching small washbasin 816341, cut-out left and right

Schubladenelement, 1 Schublade, passend zu Aufsatz-Handwaschbecken 816341, Ausschnitt links und rechts

1180 x 450 x 340 mm

Farben: .040 .041 .042 .140 .141 .142

Available from 2nd Quarter 2019

Verfügbar ab 2. Quartal 2019

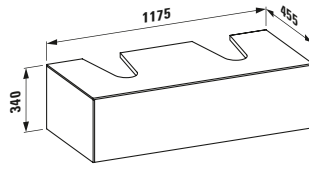

405461

Drawer element, 1 drawer, matching washbasin undersurface ground 816347, centre cut-out

Schubladenelement, 1 Schublade, passend zu Aufsatz-Waschtisch 816347, Ausschnitt Mitte

1180 x 450 x 340 mm

Farben: .040 .041 .042 .140 .141 .142

Available from 2nd Quarter 2019

Verfügbar ab 2. Quartal 2019

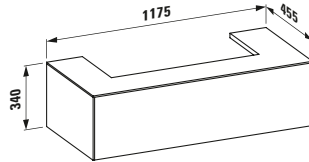

405471

Drawer element, 1 drawer, matching washbasin bowls 812348, 812349, centre cut-out

Schubladenelement, 1 Schublade, passend zu Doppelwaschtisch-Schalen 812348, 812349, Ausschnitt Mitte

1180 x 450 x 340 mm

Farben: .040 .041 .042 .140 .141 .142

Available from 2nd Quarter 2019

Verfügbar ab 2. Quartal 2019

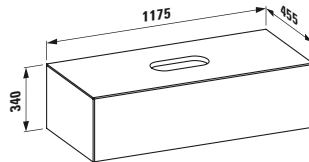

405491

Tall cabinet, 1 door, left hinged

Hochschrank, 1 Tür, Scharnier links

330 x 330 x 1600 mm

Farben: .040 .041 .042

Available from 2nd Quarter 2019

Verfügbar ab 2. Quartal 2019

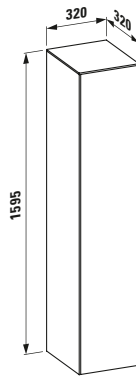

405492

Tall cabinet, 1 door, right hinged

Hochschrank, 1 Tür, Scharnier rechts

330 x 330 x 1600 mm

Farben: .040 .041 .042

Available from 2nd Quarter 2019

Verfügbar ab 2. Quartal 2019

221342

Freestanding bathtub with tap bank and surface structure, made of Marbond composite material

Freistehende Badewanne mit Armaturenbank und Oberflächenstruktur, aus Verbundwerkstoff Marbond

1600 x 815 x 460 (535) mm

Farben: .000

Optionen: .000

Available from 3rd Quarter 2019

Verfügbar ab 3. Quartal 2019

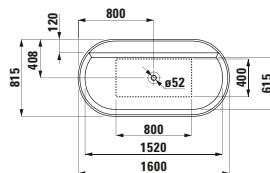

292340

Backrest, light grey

Rückenlehne, hellgrau

400 x 90 x 625 mm

Available

Verfügbar

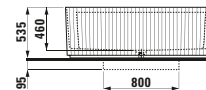

293340

Tray for Sonar bathtubs

Ablage für Sonar Badewannen

265 x 265 x 80 mm

Farben: .000

Available from 3rd Quarter 2019

Verfügbar ab 3. Quartal 2019

820339

Wall hanging Water Closet Bowl, rimless, washdown, cUPC approved

Wand-WC, Tiefspüler, spülrandlos, zugelassen nach cUPC (USA)

545 x 370 x 285 (430) mm

Farben: .000 .020 .400 .757 .759

Optionen: .000

Available from 2nd Quarter 2019

Verfügbar ab 2. Quartal 2019

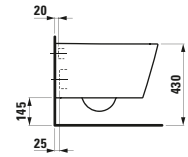
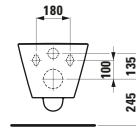
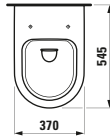

820333

Wall-hung WC ‚compact‘, washdown, rimless

Wand-WC ‚compact‘, Tiefspüler, spülrandlos

490 x 370 x 285 (430) mm

Farben: .000 .400 .757, 020, 759

Optionen: .000

Available from 3rd Quarter 2019

Verfügbar ab 3. Quartal 2019

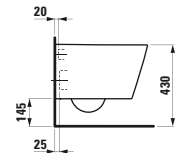
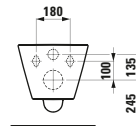
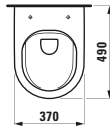

891332

WC seat and cover, removable, with round seat shape

Sitz mit Deckel, abnehmbar, mit gerundeter Sitzgeometrie

Farben: .000 .020 .757 .759

Optionen: .000

Available from 3rd Quarter 2019

Verfügbar ab 3. Quartal 2019

891333

WC seat and cover, removable, with lowering system, with round seat shape

Sitz mit Deckel, abnehmbar, mit Absenkautomatik, mit gerundeter Sitzgeometrie

Farben: .000 .020 .757 .759

Optionen: .000

Available from 3rd Quarter 2019

Verfügbar ab 3. Quartal 2019

891333

WC seat and cover, removable, with lowering system, with round seat shape

Sitz mit Deckel, abnehmbar, mit Absenkautomatik, mit gerundeter Sitzgeometrie

Farben: .000 .020 .757 .759

Optionen: .000

Available from 3rd Quarter 2019

Verfügbar ab 3. Quartal 2019

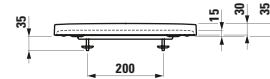
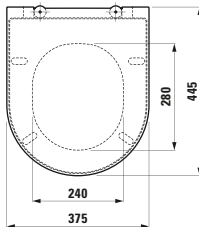

407517

Vanity unit with one glas shelf, door hinge left, open shelf right for handwashbasin tap bank left 815335 / tap bank right 815334

Waschtischunterbau, 1 Tür, Regal seitlich offen, Scharnier links passend zu Waschtisch 815335 / rechts für 815334

440 x 270 x 600 mm

Farben: .640 .641 .642

Available

Verfügbar

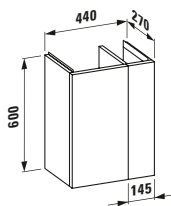

407518

Vanity unit with one glas shelf, door hinge left, open shelf right for handwashbasin tap bank left 815335 / tap bank right 815334

Waschtischunterbau, 1 Tür, Regal seitlich offen, Scharnier links passend zu Waschtisch 815335 / rechts für 815334

440 x 270 x 600 mm

Farben: .640 .641 .642

Available

Verfügbar

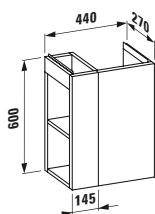

KARTELL BY LAUFEN

407508

Vanity unit with two drawers, incl. organiser, for washbasin 815331

Waschtischunterbau, 2 Schubladen, inkl. Schubladen-Ordnungssystem, passend zu Handwaschtisch 815329

440 x 450 x 600 mm

Farben: .640 .641 .642

Available

Verfügbar

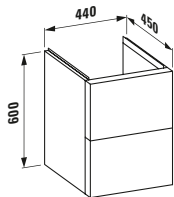

407509

Vanity unit with two drawers, incl. organiser, for washbasin 810332

Waschtischunterbau, 2 Schubladen, inkl. Schubladen-Ordnungssystem, passend zu Waschtisch 810330

480 x 450 x 600 mm

Farben: .640 .641 .642

Available

Verfügbar

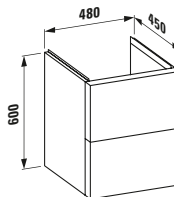

407568

Vanity unit with two drawers, incl. organiser, for washbasin shelf left 810335

Waschtischunterbau, 2 Schubladen, inkl. Schubladen-Ordnungssystem, passend zu Waschtisch 810335

580 x 450 x 600 mm

Farben: .640 .641 .642

Available

Verfügbar

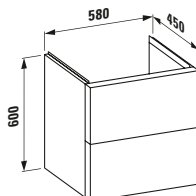

407569

Vanity unit with two drawers, incl. organiser, for washbasin 810333, 810338, 810339, 813332

Waschtischunterbau, 2 Schubladen, inkl. Schubladen-Ordnungssystem, passend zu Waschtischen 810333, 810338, 810339, 813332

580 x 450 x 600 mm

Farben: .640 .641 .642

Available

Verfügbar

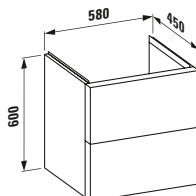

407558

Vanity unit with two drawers, incl. organiser, for washbasin shelf right 810334

Waschtischunterbau, 2 Schubladen, inkl. Schubladen-Ordnungssystem, passend zu Waschtisch 810334

580 x 450 x 600 mm

Farben: .640 .641 .642

Available

Verfügbar

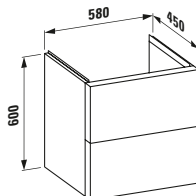

407608

Vanity unit with two drawers, incl. organiser, for washbasin shelf left 810339 / shelf right 810338

Waschtischunterbau, 2 Schubladen, inkl. Schubladen-Ordnungssystem, passend zu Waschtisch 810339 / passend zu 810338

880 x 450 x 600 mm

Farben: .640 .641 .642

Available

Verfügbar

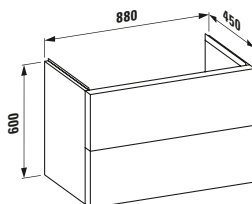

407618

Vanity unit with two drawers, incl. organiser, for washbasin shelf left 810339 / shelf right 810338

Waschtischunterbau, 2 Schubladen, inkl. Schubladen-Ordnungssystem, passend zu Waschtisch 810339 / passend zu 810338

880 x 450 x 600 mm

Farben: .640 .641 .642

Available

Verfügbar

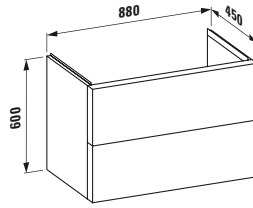

407648

Vanity unit with two drawers, incl. organiser, for washbasin shelf right 813332

Waschtischunterbau, 2 Schubladen, inkl. Schubladen-Ordnungssystem, passend zu Waschtisch 813332

1200 x 450 x 600 mm

Farben: .640 .641 .642

Available

Verfügbar

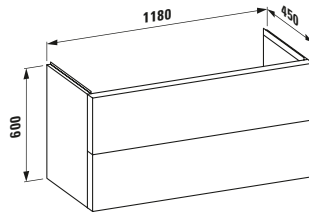

408287

Tall cabinet with 1 door, left hinged, 4 glass shelves

Hochschrank mit einer Tür, Scharnier links, 4 Glasablagen

350 x 340 x 1650 mm

Farben: .640 .641 .642

Available

Verfügbar

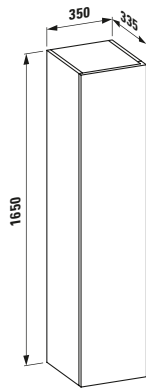

408288

Tall cabinet with 1 door, right hinged, 4 glass shelves

Hochschrank mit einer Tür, Scharnier rechts, 4 Glasablagen

350 x 335 x 1650 mm

Farben: .640 .641 .642

Available

Verfügbar



382330

Tumbler ,Boxy', plastic

Becher ,Boxy', Kunststoff

70 x 70 x 120 mm

Farben: .084 .090 .091 .092 .093

Available

Verfügbar

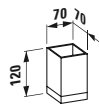

383330

Soap dish ,Boxy', plastic

Seifenschale ,Boxy', Kunststoff

105 x 105 x 25 mm

Farben: .084 .092 .094

Available

Verfügbar

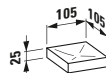

815280



Small washbasin, with tap bank right

Handwaschbecken, mit Hahnlochbank rechts

340 x 180 x 115 mm

Farben: .000 .400 .757

Optionen: .106

Available from 4th Quarter 2019

Verfügbar ab 4. Quartal 2019

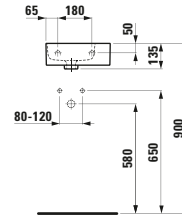
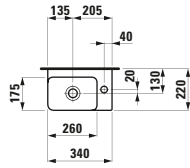

862280 VAL+BASE



Combipack, small washbasin with vanity unit, Base' with 1 door

Komplettset, Handwaschbecken mit Waschtischunterbau, Base' mit 1 Tür

340 x 220 x 640 mm

Farben: .260 .261 .262 .263 M01 M36 .999

Optionen: .106

Available from 4th Quarter 2019

Verfügbar ab 4. Quartal 2019

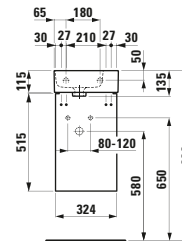
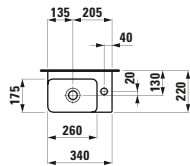

815283



Small washbasin round, shelf right, cutable to 430 mm

Handwaschbecken rund, Ablage rechts, schneidbar bis 430 mm

550 x 315 x 115 mm

Farben: .000 .400 .757

Optionen: .105 .109 .811 .813

Available from 3rd Quarter 2019

Verfügbar ab 3. Quartal 2019

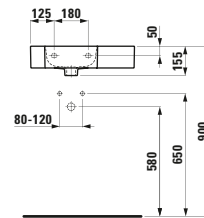
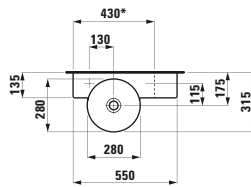

381281

Towel holder

Handtuchhalter

Farben: .004

Available from 3rd Quarter 2019

Verfügbar ab 3. Quartal 2019

815284



Small washbasin round, shelf left, cutable to 430 mm

Handwaschbecken rund, Ablage links, schneidbar bis 430 mm

550 x 315 x 115 mm

Farben: .000 .400 .757

Optionen: .106 .109 .811 .813

Available from 3rd Quarter 2019

Verfügbar ab 3. Quartal 2019

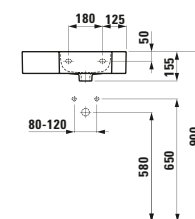
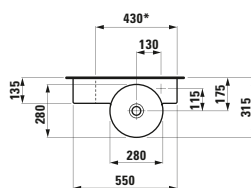

381280

Towel holder

Handtuchhalter

Farben: .004

Available from 3rd Quarter 2019

Verfügbar ab 3. Quartal 2019

815285



Washbasin ,compact', with semi-wet area right
Waschtisch ,compact', mit Halbnasszone rechts
 600 x 315 x 115 mm

Farben: .000 .400 .757

Optionen: .104 .109

Available from 3rd Quarter 2019

Verfügbar ab 3. Quartal 2019

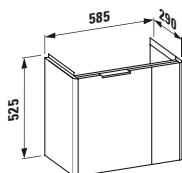
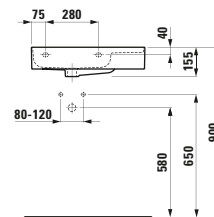
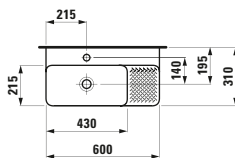

402552 BASE

Vanity unit, 2 doors
Waschtischunterbau, 2 Türen
 585 x 290 x 520 mm

Farben: .260 .261 .262 .263 M01 M36 .999

Available from 3rd Quarter 2019

Verfügbar ab 3. Quartal 2019

381282

Towel holder
Handtuchhalter

Farben: .004

Available from 3rd Quarter 2019

Verfügbar ab 3. Quartal 2019

817285



Washbasin, undersurface ground ,compact',
 with semi-wet area right

*Aufsatz-Waschtisch ,compact',
 mit Halbnasszone rechts*

600 x 315 x 115 mm

Farben: .000 .400 .757

Optionen: .104 .109

Available from 3rd Quarter 2019

Verfügbar ab 3. Quartal 2019

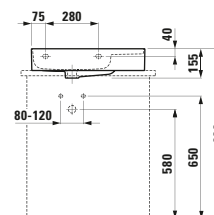
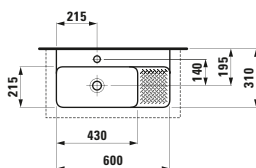

815288



Washbasin, with semi-wet area and tap bank
Waschtisch, mit Halbnasszone bzw. Hahnlochbank

530 x 400 x 115 mm

Farben: .000 .400 .757

Optionen: .106 .109

Available from 3rd Quarter 2019

Verfügbar ab 3. Quartal 2019

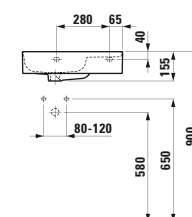
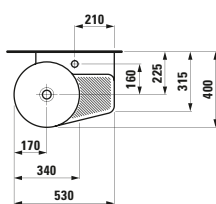

381285

Towel holder
Handtuchhalter

Farben: .004

Available from 3rd Quarter 2019

Verfügbar ab 3. Quartal 2019

816288



Washbasin, undersurface ground,
 with semi-wet area and tap bank

*Aufsatz-Waschtisch,
 mit Halbnasszone bzw. Hahnlochbank*

530 x 400 x 115 mm

Farben: .000 .400 .757

Optionen: .106 .109

Available from 3rd Quarter 2019

Verfügbar ab 3. Quartal 2019

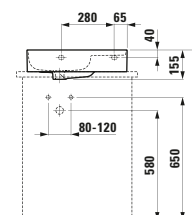
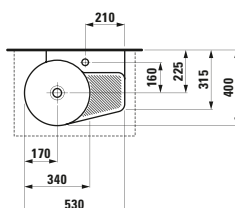

814282



Double washbasin, with semi-wet area
Doppelwaschtisch, mit Halbnasszone
 1200 x 420 x 115 mm

Farben: .000 .400 .757

Optionen: .104 .108 .109 .136

Available from 3rd Quarter 2019

Verfügbar ab 3. Quartal 2019

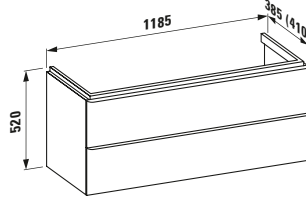
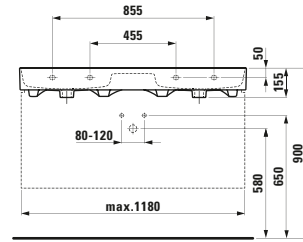
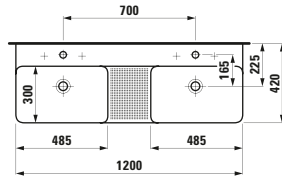

410222 SPACE

Vanity unit, 2 drawers
Waschtischunterbau, 2 Schubladen
 1185 x 410 x 520 mm

Farben: .100 .101 .103 .999

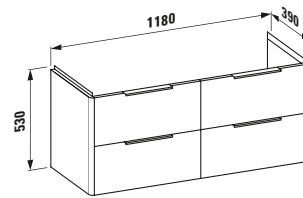

402534 BASE

Vanity unit, 4 drawers, incl. 2 drawer organizers
Waschtischunterbau, 4 Schubladen, inkl. 2 Schubladen-Ordnungssystemen
 1180 x 390 x 520 mm

Farben: .260 .261 .262 .263 M01 M36 .999

Available from 3rd Quarter 2019

Verfügbar ab 3. Quartal 2019

820288

Wall hanging Water Closet Bowl, rimless, washdown, cUPC approved

Wand-WC, Tiefspüler, spülrandlos, zugelassen nach cUPC (USA)

530 x 390 x 360 (430) mm

Farben: .000 .400 .757

Optionen: .000

Available from 2nd Quarter 2019

Verfügbar ab 2. Quartal 2019

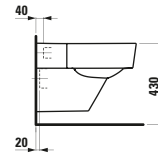
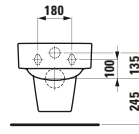
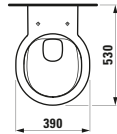

872280

Toilet roll holder, right

Papierrollenhalter, rechts

170 x 130 x 115 mm

Farben: .000 .757

Optionen: .000

Available from 3rd Quarter 2019

Verfügbar ab 3. Quartal 2019

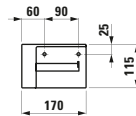

872281

Toilet roll holder, left

Papierrollenhalter, links

170 x 130 x 115 mm

Farben: .000 .757

Optionen: .000

Available from 3rd Quarter 2019

Verfügbar ab 3. Quartal 2019

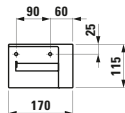

872282

Toilet brush holder incl. toilet brush

WC-Bürstengarnitur, inkl. Klosettbürste

150 x 100 x 360 mm

Farben: .000 .757

Optionen: .000

Available from 3rd Quarter 2019

Verfügbar ab 3. Quartal 2019

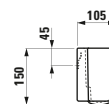

820968

Wall hanging Water Closet Bowl, rimless, washdown, cUPC approved

Wand-WC, Tiefspüler, spülrandlos, zugelassen nach cUPC (USA)

530 x 360 x 340 (430) mm

Farben: .000 .400

Optionen: .250

Available from 3rd Quarter 2019

Verfügbar ab 3. Quartal 2019

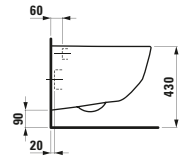
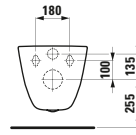
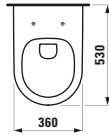

821962

Wall-hung WC ,comfort', washdown, rimless, 5 cm raised height

Wand-WC ,comfort', Tiefspüler, spülrandlos, 5 cm erhöht

560 x 360 x 450 mm

Farben: .000 .400 .018 .037 .049

Optionen: .000

Available from 3rd Quarter 2019

Verfügbar ab 3. Quartal 2019

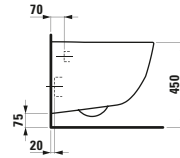
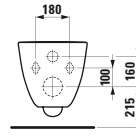
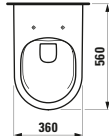

825951

Floorstanding WC close-coupled, wash-down, rimless, outlet horizontal or vertical

Stand-WC für aufgesetzten Spülkasten, Tiefspüler, spülrandlos, Abgang waagrecht oder senkrecht

700 x 360 x 440 (430) mm

Farben: .000 .400

Optionen: .000 .231

Available from 2nd Quarter 2020

Verfügbar ab 2. Quartal 2020

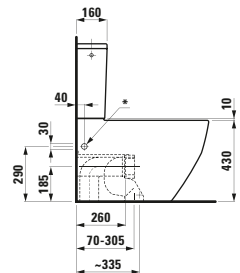
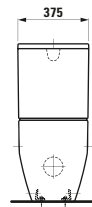
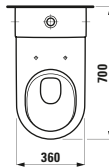

Charge 231

825958

Floorstanding WC close-coupled, washdown, rimless, outlet horizontal or vertical

Stand-WC für aufgesetzten Spülkasten, optimiert für 4.5/3L / 6/3L, Tiefspüler, spülrandlos, Abgang waagrecht oder senkrecht

700 x 360 x 440 (430) mm

Farben: .000 .400

Optionen: .000 .251* .231

Available from 4th Quarter 2019

*cUPC approved

Verfügbar ab 4. Quartal 2019

*zugelassen nach cUPC (USA)



829951

Cistern, rear water inlet (centre)

Spülkasten, Wasseranschluss hinten (mittig)

Farben: .000

Optionen: .871

829953

Cistern, water inlet bottom left

Spülkasten, Wasseranschluss unten links

Farben: .000

Optionen: .873

829952

Cistern, side water inlet (left or right)

Spülkasten, Wasseranschluss seitlich (links oder rechts)

Farben: .000

Optionen: .872

LAUFEN PRO

825962

Floorstanding WC close-coupled, washdown, rimless, outlet horizontal or vertical

Stand-WC für aufgesetzten Spülkasten, Tiefspüler, spülrandlos, Abgang waagrecht oder senkrecht

650 x 360 x 440 (430) mm

Farben: .000 .400

Optionen: .000 .231

Available from 1st Quarter 2020

Verfügbar ab 1. Quartal 2020

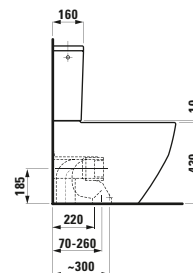
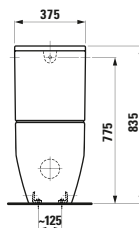
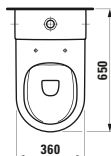

829951

Cistern, rear water inlet (centre)

Spülkasten, Wasseranschluss hinten (mittig)

Farben: .000

Optionen: .871

829952

Cistern, side water inlet (left or right)

Spülkasten, Wasseranschluss seitlich (links oder rechts)

Farben: .000

Optionen: .872

829953

Cistern, water inlet bottom left

Spülkasten, Wasseranschluss unten links

Farben: .000

Optionen: .873

829951

Cistern, rear water inlet (centre)

Spülkasten, Wasseranschluss hinten (mittig)

365 x 150 x 395 mm

Farben: .000

Optionen: .871

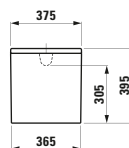

829952

Cistern, side water inlet (left or right)

Spülkasten, Wasseranschluss seitlich (links oder rechts)

365 x 150 x 395 mm

Farben: .000

Optionen: .872

829953

Cistern, water inlet bottom left

Spülkasten, Wasseranschluss unten links

365 x 150 x 395 mm

Farben: .000

Optionen: .873

821952

Wall-hung WC 'compact', washdown, rimless

Wand-WC 'compact', Tiefspüler, spülrandlos

490 x 360 x 350 (430) mm

Farben: .000 .400

Optionen: .000

Available from 4th Quarter 2019

Verfügbar ab 4. Quartal 2019

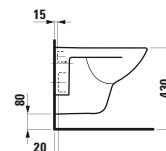
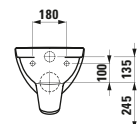
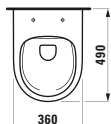

891601

Seat and cover, removable, with lowering system, hollow space fixation

WC-Sitz mit Deckel abnehmbar, mit Absenkautomatik, für Hohlraumbefestigung

Farben: .000 .757

Optionen: .000

Available from 2nd Quarter 2019

Verfügbar ab 2. Quartal 2019

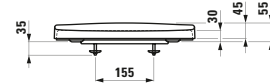
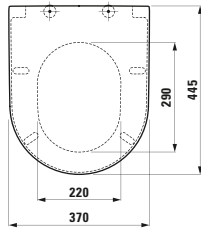

821954 PRO LIBERTY

Wall-hung WC ‚liberty‘, washdown, rimless, barrier-free



Wand-WC ‚liberty‘, Tiefspüler, spülrandlos, barrierefrei

700 x 360 x 350 (450) mm

Farben: .000 .400 .018 .037

Optionen: .000

Available from 4th Quarter 2019

Verfügbar ab 4. Quartal 2019

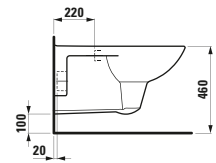
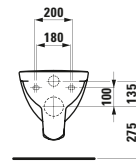
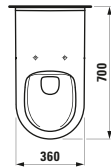

242950

Bathtub, rectangular, made of Marbond composite material, drop-in version

Badewanne, Einbauversion, rechteckig, aus Verbundwerkstoff Marbond

1700 x 750 x 460 mm

Farben: .000

Optionen: .000

Available

Verfügbar

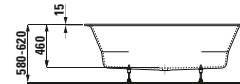
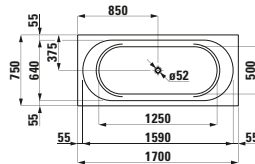

240950

Bathtub, rectangular, made of Marbond composite material, drop-in version

Badewanne, Einbauversion, rechteckig, aus Verbundwerkstoff Marbond

1800 x 800 x 460 mm

Farben: .000

Optionen: .000

Available

Verfügbar

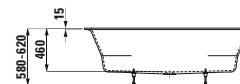
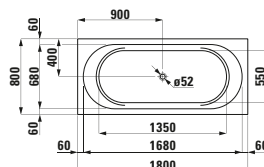

241950

Bathtub, drop-in version, oval, made of Marbond composite material

Badewanne, Einbauversion, oval, aus Verbundwerkstoff Marbond

1800 x 800 x 460 mm

Farben: .000

Optionen: .000

Available

Verfügbar

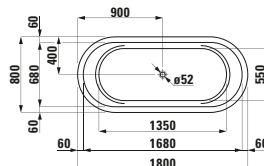

243952

Freestanding bathtub, made of Marbond composite material

Freistehende Badewanne, aus Verbundwerkstoff Marbond

1500 x 700 x 590 mm

Farben: .000

Optionen: .000

Available

Verfügbar

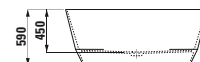
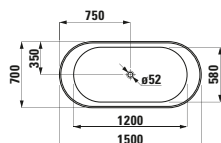

LAUFEN PRO

210950

Shower tray, made of Marbond composite material, super flat, square, outlet at side

Duschwanne, aus Verbundwerkstoff Marbond, superflach, quadratisch, Ablauf seitlich

800 x 800 x 29 mm

Farben: .000 .077 .078

Optionen: .000

Available from 2nd Quarter 2019
Also suitable for flush installation

Verfügbar ab 2. Quartal 2019

Auch für flächenbündigen Einbau geeignet

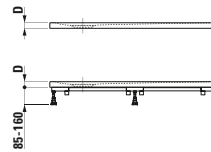
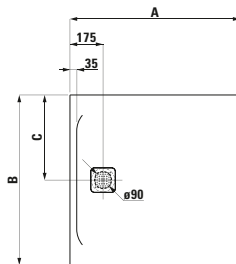

210956

Shower tray, made of Marbond composite material, super flat, square, outlet at side

Duschwanne, aus Verbundwerkstoff Marbond, superflach, quadratisch, Ablauf seitlich

900 x 900 x 30 mm

Farben: .000 .077 .078

Optionen: .000

Available from 2nd Quarter 2019
Also suitable for flush installation

Verfügbar ab 2. Quartal 2019

Auch für flächenbündigen Einbau geeignet

211952

Shower tray, made of Marbond composite material, super flat, square, outlet at side

Duschwanne, aus Verbundwerkstoff Marbond, superflach, quadratisch, Ablauf seitlich

1000 x 1000 x 33 mm

Farben: .000 .077 .078

Optionen: .000

Available from 2nd Quarter 2019
Also suitable for flush installation

Verfügbar ab 2. Quartal 2019

Auch für flächenbündigen Einbau geeignet

211958

Shower tray, made of Marbond composite material, super flat, square, outlet at side

Duschwanne, aus Verbundwerkstoff Marbond, superflach, quadratisch, Ablauf seitlich

1200 x 1200 x 33 mm

Farben: .000 .077 .078

Optionen: .000

Available from 2nd Quarter 2019
Also suitable for flush installation

Verfügbar ab 2. Quartal 2019

Auch für flächenbündigen Einbau geeignet

210951

Shower tray, made of Marbond composite material, super flat, rectangular, outlet at short side

Duschwanne, aus Verbundwerkstoff Marbond, superflach, rechteckig, Ablauf an kurzer Seite

1000 x 800 x 33 mm

Farben: .000 .077 .078

Optionen: .000

Available from 2nd Quarter 2019

Also suitable for flush installation

Verfügbar ab 2. Quartal 2019

Auch für flächenbündigen Einbau geeignet

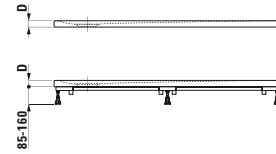
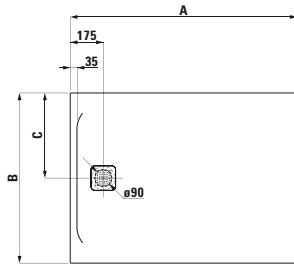

210957

Shower tray, made of Marbond composite material, super flat, rectangular, outlet at short side

Duschwanne, aus Verbundwerkstoff Marbond, superflach, rechteckig, Ablauf an kurzer Seite

1000 x 900 x 33 mm

Farben: .000 .077 .078

Optionen: .000

Available from 2nd Quarter 2019

Also suitable for flush installation

Verfügbar ab 2. Quartal 2019

Auch für flächenbündigen Einbau geeignet

212954

Shower tray, made of Marbond composite material, super flat, rectangular, outlet at short side

Duschwanne, aus Verbundwerkstoff Marbond, superflach, rechteckig, Ablauf an kurzer Seite

1100 x 800 x 33 mm

Farben: .000 .077 .078

Optionen: .000

Available from 2nd Quarter 2019

Also suitable for flush installation

Verfügbar ab 2. Quartal 2019

Auch für flächenbündigen Einbau geeignet

212955

Shower tray, made of Marbond composite material, super flat, rectangular, outlet at short side

Duschwanne, aus Verbundwerkstoff Marbond, superflach, rechteckig, Ablauf an kurzer Seite

1100 x 900 x 33 mm

Farben: .000 .077 .078

Optionen: .000

Available from 2nd Quarter 2019

Also suitable for flush installation

Verfügbar ab 2. Quartal 2019

Auch für flächenbündigen Einbau geeignet

LAUFEN PRO

215954

Shower tray, made of Marbond composite material, super flat, rectangular, outlet at long side

Duschwanne, aus Verbundwerkstoff Marbond, superflach, rechteckig, Ablauf an langer Seite

1400 x 700 x 30 mm

Farben: .000 .077 .078

Optionen: .000

Available from 2nd Quarter 2019
Also suitable for flush installation

*Verfügbar ab 2. Quartal 2019
Auch für flächenbündigen Einbau geeignet*

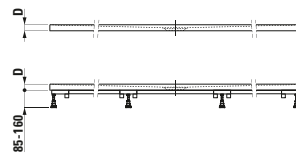
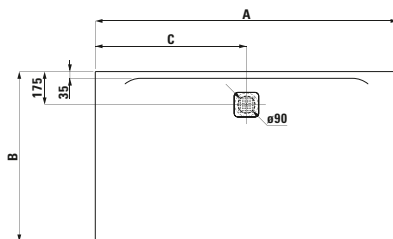

210953

Shower tray, made of Marbond composite material, super flat, rectangular, outlet at long side

Duschwanne, aus Verbundwerkstoff Marbond, superflach, rechteckig, Ablauf an langer Seite

1400 x 800 x 30 mm

Farben: .000 .077 .078

Optionen: .000

Available from 2nd Quarter 2019
Also suitable for flush installation

*Verfügbar ab 2. Quartal 2019
Auch für flächenbündigen Einbau geeignet*

210959

Shower tray, made of Marbond composite material, super flat, rectangular, outlet at long side

Duschwanne, aus Verbundwerkstoff Marbond, superflach, rechteckig, Ablauf an langer Seite

1400 x 900 x 30 mm

Farben: .000 .077 .078

Optionen: .000

Available from 2nd Quarter 2019
Also suitable for flush installation

*Verfügbar ab 2. Quartal 2019
Auch für flächenbündigen Einbau geeignet*

211954

Shower tray, made of Marbond composite material, super flat, rectangular, outlet at long side

Duschwanne, aus Verbundwerkstoff Marbond, superflach, rechteckig, Ablauf an langer Seite

1400 x 1000 x 30 mm

Farben: .000 .077 .078

Optionen: .000

Available from 2nd Quarter 2019
Also suitable for flush installation

*Verfügbar ab 2. Quartal 2019
Auch für flächenbündigen Einbau geeignet*

212950

Shower tray, made of Marbond composite material, super flat, made-to-measure

Duschwanne, aus Verbundwerkstoff Marbond, superflach, auf Maß gefertigt

750 - 2000 x 700 - 1000 x 29 - 46 mm

Farben: .000 .077 .078

Optionen: .000

Available from 2nd Quarter 2019

Verfügbar ab 2. Quartal 2019

860702

Combipack 600 mm, washbasin ,slim'
with vanity unit with 2 drawers, incl. drawer organizer,
with handle anodized aluminum

*Komplettset 600 mm, Waschtisch ,slim'
mit Waschtischunterbau mit 2 Schubladen,
inkl. Schubladen-Ordnungssystem,
mit Griff Aluminium eloxiert*

600 x 450 x 545 mm

Farben: .260 .261 .262 .263 .266 .999

Optionen: .104

Available from 2nd quarter 2019

Verfügbar ab 2. Quartal 2019

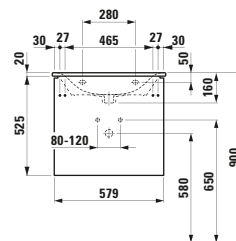
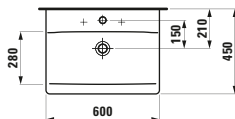

861702

Combipack 600 mm, washbasin ,slim'
with vanity unit with 2 drawers, incl. drawer organizer,
with handle aluminum black

*Komplettset 600 mm, Waschtisch ,slim'
mit Waschtischunterbau mit 2 Schubladen,
inkl. Schubladen-Ordnungssystem,
mit Griff Aluminium schwarz*

600 x 450 x 545 mm

Farben: .260 .261 .262 .263 .266 .999

Optionen: .104

Available from 2nd quarter 2019

Verfügbar ab 2. Quartal 2019

860705

Combipack 800 mm, washbasin ,slim'
with vanity unit with 2 drawers, incl. drawer organizer,
with handle anodized aluminum

*Komplettset 800 mm, Waschtisch ,slim'
mit Waschtischunterbau mit 2 Schubladen,
inkl. Schubladen-Ordnungssystem,
mit Griff Aluminium eloxiert*

800 x 450 x 545 mm

Farben: .260 .261 .262 .263 .266 .999

Optionen: .104

Available from 4th quarter 2019

Verfügbar ab 4. Quartal 2019

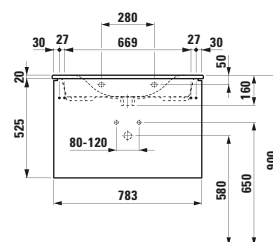
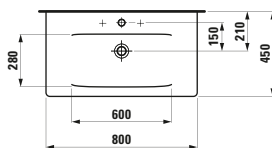

861705

Combipack 800 mm, washbasin ,slim'
with vanity unit with 2 drawers, incl. drawer organizer,
with handle aluminum black

*Komplettset 800 mm, Waschtisch ,slim'
mit Waschtischunterbau mit 2 Schubladen,
inkl. Schubladen-Ordnungssystem,
mit Griff Aluminium schwarz*

800 x 450 x 545 mm

Farben: .260 .261 .262 .263 .266 .999

Optionen: .104

Available from 4th quarter 2019

Verfügbar ab 4. Quartal 2019

PALACE

860707

Combipack 1000 mm, washbasin ,slim' with vanity unit with 2 drawers, incl. drawer organizer, with handle anodized aluminum

Komplettset 1000 mm, Waschtisch ,slim' mit Waschtischunterbau mit 2 Schubladen, inkl. Schubladen-Ordnungssystem, mit Griff Aluminium eloxiert

1000 x 450 x 545 mm

Farben: .260 .261 .262 .263 .266 .999

Optionen: .104

Available from 4th quarter 2019

Verfügbar ab 4. Quartal 2019

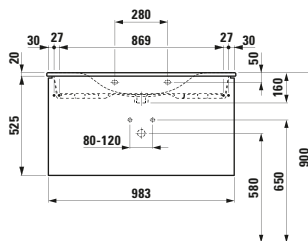
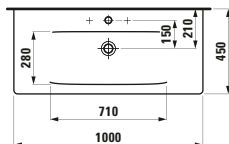

861707

Combipack 1000 mm, washbasin ,slim' with vanity unit with 2 drawers, incl. drawer organizer, with handle aluminum black

Komplettset 1000 mm, Waschtisch ,slim' mit Waschtischunterbau mit 2 Schubladen, inkl. Schubladen-Ordnungssystem, mit Griff Aluminium schwarz

1000 x 450 x 545 mm

Farben: .260 .261 .262 .263 .266 .999

Optionen: .104

Available from 4th quarter 2019

Verfügbar ab 4. Quartal 2019

403031 BASE

Tall cabinet, 1 door, with handle anodized aluminum, left hinged

Hochschrank, 1 Tür, mit Griff Aluminium eloxiert, Scharnier links

350 x 330 x 1650 mm

Farben: .260 .261 .262 .263 .266 .999

Available from 2nd Quarter 2019

Verfügbar ab 2. Quartal 2019

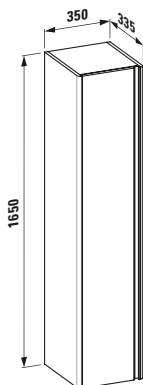

403033 BASE

Tall cabinet, 1 door, with handle aluminum black, left hinged

Hochschrank, 1 Tür, mit Griff Aluminium schwarz, Scharnier links

350 x 330 x 1650 mm

Farben: .260 .261 .262 .263 .266 .999

Available from 2nd Quarter 2019

Verfügbar ab 2. Quartal 2019

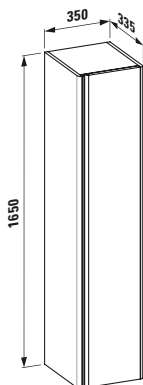

403032 BASE

Tall cabinet, 1 door, with handle anodized aluminum, right hinged

Hochschrank, 1 Tür, mit Griff Aluminium eloxiert, Scharnier rechts

350 x 330 x 1650 mm

Farben: .260 .261 .262 .263 .266 .999

Available from 2nd Quarter 2019

Verfügbar ab 2. Quartal 2019

403034 BASE

Tall cabinet, 1 door, with handle aluminum black, right hinged

Hochschrank, 1 Tür, mit Griff Aluminium schwarz, Scharnier rechts

350 x 330 x 1650 mm

Farben: .260 .261 .262 .263 .266 .999

Available from 2nd Quarter 2019

Verfügbar ab 2. Quartal 2019

403011 BASE

Vanity unit, 1 door, left hinged, 1 internal shelf, with handle anodized aluminum / aluminium black, matching small washbasin 815301

Waschtischunterbau, 1 Tür, Scharnier links, 1 Innenablage, mit Griff Aluminium eloxiert / schwarz, passend zu Handwaschbecken 815301

280 x 300 x 520 mm

Farben: .260 .261 .262 .263 .266 .999

Available from 3rd Quarter 2019

Verfügbar ab 3. Quartal 2019

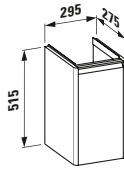

403013 BASE

Vanity unit, 1 door, left hinged, 1 internal shelf, with handle anodized aluminum / aluminium black, matching small washbasin 815301

Waschtischunterbau, 1 Tür, Scharnier links, 1 Innenablage, mit Griff Aluminium eloxiert / schwarz, passend zu Handwaschbecken 815301

280 x 300 x 520 mm

Farben: .260 .261 .262 .263 .266 .999

Available from 3rd Quarter 2019

Verfügbar ab 3. Quartal 2019

403012 BASE

Vanity unit, 1 door, right hinged, 1 internal shelf, with handle anodized aluminum / aluminium black, matching small washbasin 815301

Waschtischunterbau, 1 Tür, Scharnier rechts, 1 Innenablage, mit Griff Aluminium eloxiert / schwarz, passend zu Handwaschbecken 815301

280 x 300 x 520 mm

Farben: .260 .261 .262 .263 .266 .999

Available from 3rd Quarter 2019

Verfügbar ab 3. Quartal 2019

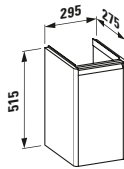

403014 BASE

Vanity unit, 1 door, right hinged, 1 internal shelf, with handle anodized aluminum / aluminium black, matching small washbasin 815301

Waschtischunterbau, 1 Tür, Scharnier rechts, 1 Innenablage, mit Griff Aluminium eloxiert / schwarz, passend zu Handwaschbecken 815301

280 x 300 x 520 mm

Farben: .260 .261 .262 .263 .266 .999

Available from 3rd Quarter 2019

Verfügbar ab 3. Quartal 2019

403021 BASE

Vanity unit, 1 door, left hinged, 1 internal shelf,
with handle anodized aluminum / aluminium black,
matching washbasin 810302

*Waschtischunterbau, 1 Tür, Scharnier links,
1 Innenablage, mit Griff Aluminium eloxiert / schwarz,
passend zu Waschtisch 810302*

320 x 340 x 520 mm

Farben: .260 .261 .262 .263 .266 .999

Available from 3rd Quarter 2019

Verfügbar ab 3. Quartal 2019

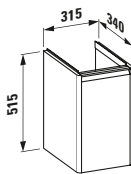

403023 BASE

Vanity unit, 1 door, left hinged, 1 internal shelf,
with handle anodized aluminum / aluminium black,
matching washbasin 810302

*Waschtischunterbau, 1 Tür, Scharnier links, 1
Innenablage, mit Griff Aluminium eloxiert / schwarz,
passend zu Waschtisch 810302*

320 x 340 x 520 mm

Farben: .260 .261 .262 .263 .266 .999

Available from 3rd Quarter 2019

Verfügbar ab 3. Quartal 2019

403022 BASE

Vanity unit, 1 door, right hinged, 1 internal shelf,
with handle anodized aluminum / aluminium black,
matching washbasin 810302

*Waschtischunterbau, 1 Tür, Scharnier rechts,
1 Innenablage, mit Griff Aluminium eloxiert / schwarz,
passend zu Waschtisch 810302*

320 x 340 x 520 mm

Farben: .260 .261 .262 .263 .266 .999

Available from 3rd Quarter 2019

Verfügbar ab 3. Quartal 2019

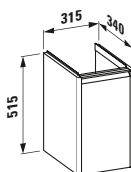

403024 BASE

Vanity unit, 1 door, right hinged, 1 internal shelf,
with handle anodized aluminum / aluminium black,
matching washbasin 810302

*Waschtischunterbau, 1 Tür, Scharnier rechts,
1 Innenablage, mit Griff Aluminium eloxiert / schwarz,
passend zu Waschtisch 810302*

320 x 340 x 520 mm

Farben: .260 .261 .262 .263 .266 .999

Available from 3rd Quarter 2019

Verfügbar ab 3. Quartal 2019

403001 BASE

Vanity unit, 1 drawer, with handle anodized aluminum / aluminium black, matching vanity washbasins 813301, 813302

Waschtischunterbau, 1 Schublade, mit Griff Aluminium eloxiert / schwarz, passend zu Möbelwaschtischen 813301, 813302

770 x 350 x 370 mm

Farben: .260 .261 .262 .263 .266 .999

Available from 3rd Quarter 2019

Verfügbar ab 3. Quartal 2019

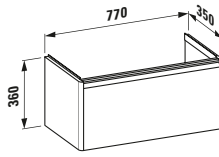

403003 BASE

Vanity unit, 1 drawer, with handle anodized aluminum / aluminium black, matching vanity washbasins 813301, 813302

Waschtischunterbau, 1 Schublade, mit Griff Aluminium eloxiert / schwarz, passend zu Möbelwaschtischen 813301, 813302

770 x 350 x 370 mm

Farben: .260 .261 .262 .263 .266 .999

Available from 3rd Quarter 2019

Verfügbar ab 3. Quartal 2019

403002 BASE

Vanity unit, 2 drawers, floorstanding, with handle anodized aluminum / aluminium black, matching vanity washbasins 813301, 813302

Waschtischunterbau, 2 Schubladen, bodenstehend, mit Griff Aluminium eloxiert / schwarz, passend zu Möbelwaschtischen 813301; 813302

770 x 350 x 780 mm

Farben: .260 .261 .262 .263 .266 .999

Available from 3rd Quarter 2019

Verfügbar ab 3. Quartal 2019

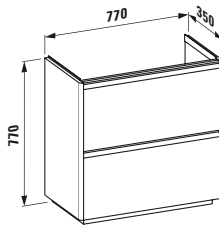

403004 BASE

Vanity unit, 2 drawers, floorstanding, with handle anodized aluminum / aluminium black, matching vanity washbasins 813301, 813302

Waschtischunterbau, 2 Schubladen, bodenstehend, mit Griff Aluminium eloxiert / schwarz, passend zu Möbelwaschtischen 813301; 813302

770 x 350 x 780 mm

Farben: .260 .261 .262 .263 .266 .999

Available from 3rd Quarter 2019

Verfügbar ab 3. Quartal 2019

403031 BASE

Tall cabinet, 1 door, with handle anodized aluminum, left hinged

Hochschrank, 1 Tür, mit Griff Aluminium eloxiert, Scharnier links

350 x 330 x 1650 mm

Farben: .260 .261 .262 .263 .266 .999

Available from 3rd Quarter 2019

Verfügbar ab 3. Quartal 2019

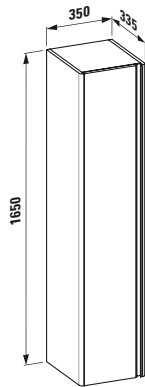

403033 BASE

Tall cabinet, 1 door, with handle aluminum black, left hinged

Hochschrank, 1 Tür, mit Griff Aluminium schwarz, Scharnier links

350 x 330 x 1650 mm

Farben: .260 .261 .262 .263 .266 .999

Available from 3rd Quarter 2019

Verfügbar ab 3. Quartal 2019

403032 BASE

Tall cabinet, 1 door, with handle anodized aluminum, right hinged

Hochschrank, 1 Tür, mit Griff Aluminium eloxiert, Scharnier rechts

350 x 330 x 1650 mm

Farben: .260 .261 .262 .263 .266 .999

Available from 3rd Quarter 2019

Verfügbar ab 3. Quartal 2019

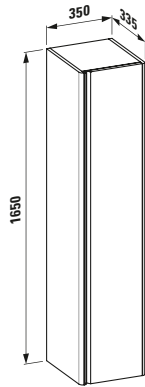

403034 BASE

Tall cabinet, 1 door, with handle aluminum black, right hinged

Hochschrank, 1 Tür, mit Griff Aluminium schwarz, Scharnier rechts

350 x 330 x 1650 mm

Farben: .260 .261 .262 .263 .266 .999

Available from 3rd Quarter 2019

Verfügbar ab 3. Quartal 2019

447611 LEELO

Mirror, 450 mm with integrated horizontal LED lighting, for room switch, aluminium frame, 4000K, IP44

Spiegel, 450 mm, mit integrierter horizontaler LED-Beleuchtung, für Lichtschalter, Aluminiumrahmen, 4000K, IP44

450 x 38 x 800 mm

Farben: .144

Available from 2nd Quarter 2019

Verfügbar ab 2. Quartal 2019

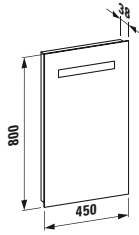

447612 LEELO

Mirror, 450 mm with integrated horizontal LED lighting, 1 touch sensor (On/ Off/ Dimmer), aluminium frame, 4000K, IP44

Spiegel, 450 mm, mit integrierter horizontaler LED-Beleuchtung, 1 Touch Sensorschalter (An/ Aus/ Dimmer), Aluminiumrahmen, 4000K, IP44

450 x 38 x 800 mm

Farben: .144

Available from 2nd Quarter 2019

Verfügbar ab 2. Quartal 2019

447613 LEELO

Mirror, 450 mm with integrated horizontal LED lighting and ambient light, 3 touch sensors (On-Off/ Dimmer/ Colour temperature change 2700-6000K), aluminium frame, IP44

Spiegel, 450 mm, mit integrierter horizontaler LED-Beleuchtung und Ambientlicht, 3 Touch Sensorschalter (An-Aus/ Dimmer/ Farbtemperaturwechsel 2700-6000K), Aluminiumrahmen, IP44

450 x 32 x 800 mm

Farben: .144

Available from 2nd Quarter 2019

Verfügbar ab 2. Quartal 2019

LEELO MIRRORS

447621 LEELO

Mirror, 550 mm with integrated horizontal LED lighting, for room switch, aluminium frame, 4000K, IP44

Spiegel, 550 mm, mit integrierter horizontaler LED-Beleuchtung, für Lichtschalter, Aluminiumrahmen, 4000K, IP44

550 x 38 x 800 mm

Farben: .144

Available from 2nd Quarter 2019

Verfügbar ab 2. Quartal 2019

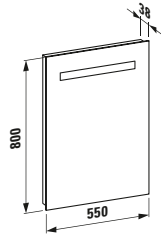

447622 LEELO

Mirror, 550 mm with integrated horizontal LED lighting, 1 touch sensor (On/ Off/ Dimmer), aluminium frame, 4000K, IP44

Spiegel, 550 mm, mit integrierter horizontaler LED-Beleuchtung, 1 Touch Sensorschalter (An/ Aus/ Dimmer), Aluminiumrahmen, 4000K, IP44

550 x 38 x 800 mm

Farben: .144

Available from 2nd Quarter 2019

Verfügbar ab 2. Quartal 2019

447623 LEELO

Mirror, 550 mm with integrated horizontal LED lighting and ambient light, 3 touch sensors (On-Off/ Dimmer/ Colour temperature change 2700-6000K), aluminium frame, IP44

Spiegel, 550 mm, mit integrierter horizontaler LED-Beleuchtung und Ambientlicht, 3 Touch Sensorschalter (An-Aus/ Dimmer/ Farbtemperaturwechsel 2700-6000K), Aluminiumrahmen, IP44

550 x 32 x 800 mm

Farben: .144

Available from 2nd Quarter 2019

Verfügbar ab 2. Quartal 2019

447631 LEELO

Mirror, 600 mm with integrated horizontal LED lighting, for room switch, aluminium frame, 4000K, IP44

Spiegel, 600 mm, mit integrierter horizontaler LED-Beleuchtung, für Lichtschalter, Aluminiumrahmen, 4000K, IP44

600 x 38 x 700 mm

Farben: .144

Available from 2nd Quarter 2019

Verfügbar ab 2. Quartal 2019

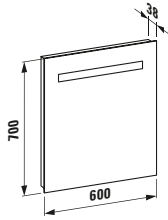

447632 LEELO

Mirror, 600 mm with integrated horizontal LED lighting, 1 touch sensor (On/ Off/ Dimmer), aluminium frame, 4000K, IP44

Spiegel, 600 mm, mit integrierter horizontaler LED-Beleuchtung, 1 Touch Sensorschalter (An/ Aus/ Dimmer), Aluminiumrahmen, 4000K, IP44

600 x 38 x 700 mm

Farben: .144

Available from 2nd Quarter 2019

Verfügbar ab 2. Quartal 2019

447633 LEELO

Mirror, 600 mm with integrated horizontal LED lighting and ambient light, 3 touch sensors (On-Off/ Dimmer/ Colour temperature change 2700-6000K), aluminium frame, IP44

Spiegel, 600 mm, mit integrierter horizontaler LED-Beleuchtung und Ambientlicht, 3 Touch Sensorschalter (An-Aus/ Dimmer/ Farbtemperaturwechsel 2700-6000K), Aluminiumrahmen, IP44

600 x 32 x 700 mm

Farben: .144

Available from 2nd Quarter 2019

Verfügbar ab 2. Quartal 2019

LEELO MIRRORS

447641 LEELO

Mirror, 800 mm with integrated horizontal LED lighting, for room switch, aluminium frame, 4000K, IP44

Spiegel, 800 mm, mit integrierter horizontaler LED-Beleuchtung, für Lichtschalter, Aluminiumrahmen, 4000K, IP44

800 x 38 x 700 mm

Farben: .144

Available from 2nd Quarter 2019

Verfügbar ab 2. Quartal 2019

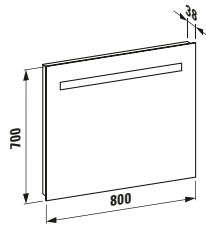

447642 LEELO

Mirror, 800 mm with integrated horizontal LED lighting, 1 touch sensor (On/ Off/ Dimmer), aluminium frame, 4000K, IP44

Spiegel, 800 mm, mit integrierter horizontaler LED-Beleuchtung, 1 Touch Sensorschalter (An/ Aus/ Dimmer), Aluminiumrahmen, 4000K, IP44

800 x 38 x 700 mm

Farben: .144

Available from 2nd Quarter 2019

Verfügbar ab 2. Quartal 2019

447643 LEELO

Mirror, 800 mm with integrated horizontal LED lighting and ambient light, 3 touch sensors (On-Off/ Dimmer/ Colour temperature change 2700-6000K), aluminium frame, IP44

Spiegel, 800 mm, mit integrierter horizontaler LED-Beleuchtung und Ambientlicht, 3 Touch Sensorschalter (An-Aus/ Dimmer/ Farbtemperaturwechsel 2700-6000K), Aluminiumrahmen, IP44

800 x 32 x 700 mm

Farben: .144

Available from 2nd Quarter 2019

Verfügbar ab 2. Quartal 2019

447651 LEELO

Mirror, 900 mm with integrated horizontal LED lighting, for room switch, aluminium frame, 4000K, IP44

Spiegel, 900 mm, mit integrierter horizontaler LED-Beleuchtung, für Lichtschalter, Aluminiumrahmen, 4000K, IP44

900 x 38 x 700 mm

Farben: .144

Available from 2nd Quarter 2019

Verfügbar ab 2. Quartal 2019

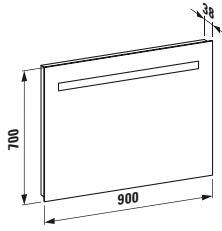

447652 LEELO

Mirror, 900 mm with integrated horizontal LED lighting, 1 touch sensor (On/ Off/ Dimmer), aluminium frame, 4000K, IP44

Spiegel, 900 mm, mit integrierter horizontaler LED-Beleuchtung, 1 Touch Sensorschalter (An/ Aus/ Dimmer), Aluminiumrahmen, 4000K, IP44

900 x 38 x 700 mm

Farben: .144

Available from 2nd Quarter 2019

Verfügbar ab 2. Quartal 2019

447653 LEELO

Mirror, 900 mm with integrated horizontal LED lighting and ambient light, 3 touch sensors (On-Off/ Dimmer/ Colour temperature change 2700-6000K), aluminium frame, IP44

Spiegel, 900 mm, mit integrierter horizontaler LED-Beleuchtung und Ambientlicht, 3 Touch Sensorschalter (An-Aus/ Dimmer/ Farbtemperaturwechsel 2700-6000K), Aluminiumrahmen, IP44

900 x 32 x 700 mm

Farben: .144

Available from 2nd Quarter 2019

Verfügbar ab 2. Quartal 2019

LEELO MIRRORS

447661 LEELO

Mirror, 1000 mm with integrated horizontal LED lighting, for room switch, aluminium frame, 4000K, IP44

Spiegel, 1000 mm, mit integrierter horizontaler LED-Beleuchtung, für Lichtschalter, Aluminiumrahmen, 4000K, IP44

1000 x 38 x 700 mm

Farben: .144

Available from 2nd Quarter 2019

Verfügbar ab 2. Quartal 2019

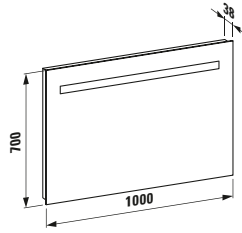

447662 LEELO

Mirror, 1000 mm with integrated horizontal LED lighting, 1 touch sensor (On/ Off/ Dimmer), aluminium frame, 4000K, IP44

Spiegel, 1000 mm, mit integrierter horizontaler LED-Beleuchtung, 1 Touch Sensorschalter (An/ Aus/ Dimmer), Aluminiumrahmen, 4000K, IP44

1000 x 38 x 700 mm

Farben: .144

Available from 2nd Quarter 2019

Verfügbar ab 2. Quartal 2019

447663 LEELO

Mirror, 1000 mm with integrated horizontal LED lighting and ambient light, 3 touch sensors (On-Off/ Dimmer/ Colour temperature change 2700-6000K), aluminium frame, IP44

Spiegel, 1000 mm, mit integrierter horizontaler LED-Beleuchtung und Ambientlicht, 3 Touch Sensorschalter (An-Aus/ Dimmer/ Farbtemperaturwechsel 2700-6000K), Aluminiumrahmen, IP44

1000 x 32 x 700 mm

Farben: .144

Available from 2nd Quarter 2019

Verfügbar ab 2. Quartal 2019

447671 LEELO

Mirror, 1200 mm with integrated horizontal LED lighting, for room switch, aluminium frame, 4000K, IP44

Spiegel, 1200 mm, mit integrierter horizontaler LED-Beleuchtung, für Lichtschalter, Aluminiumrahmen, 4000K, IP44

1200 x 38 x 700 mm

Farben: .144

Available from 2nd Quarter 2019

Verfügbar ab 2. Quartal 2019

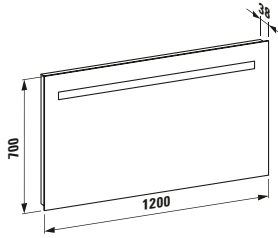

447672 LEELO

Mirror, 1200 mm with integrated horizontal LED lighting, 1 touch sensor (On/ Off/ Dimmer), aluminium frame, 4000K, IP44

Spiegel, 1200 mm, mit integrierter horizontaler LED-Beleuchtung, 1 Touch Sensorschalter (An/ Aus/ Dimmer), Aluminiumrahmen, 4000K, IP44

1200 x 38 x 700 mm

Farben: .144

Available from 2nd Quarter 2019

Verfügbar ab 2. Quartal 2019

447673 LEELO

Mirror, 1200 mm with integrated horizontal LED lighting and ambient light, 3 touch sensors (On-Off/ Dimmer/ Colour temperature change 2700-6000K), aluminium frame, IP44

Spiegel, 1200 mm, mit integrierter horizontaler LED-Beleuchtung und Ambientlicht, 3 Touch Sensorschalter (An-Aus/ Dimmer/ Farbtemperaturwechsel 2700-6000K), Aluminiumrahmen, IP44

1200 x 32 x 700 mm

Farben: .144

Available from 2nd Quarter 2019

Verfügbar ab 2. Quartal 2019

LEELO MIRRORS

447681 LEELO

Mirror, 1300 mm with integrated horizontal LED lighting, for room switch, aluminium frame, 4000K, IP44

Spiegel, 1300 mm, mit integrierter horizontaler LED-Beleuchtung, für Lichtschalter, Aluminiumrahmen, 4000K, IP44

1300 x 38 x 700 mm

Farben: .144

Available from 2nd Quarter 2019

Verfügbar ab 2. Quartal 2019

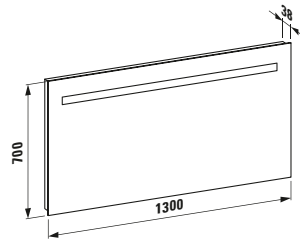

447682 LEELO

Mirror, 1300 mm with integrated horizontal LED lighting, 1 touch sensor (On/ Off/ Dimmer), aluminium frame, 4000K, IP44

Spiegel, 1300 mm, mit integrierter horizontaler LED-Beleuchtung, 1 Touch Sensorschalter (An/ Aus/ Dimmer), Aluminiumrahmen, 4000K, IP44

1300 x 38 x 700 mm

Farben: .144

Available from 2nd Quarter 2019

Verfügbar ab 2. Quartal 2019

447683 LEELO

Mirror, 1300 mm with integrated horizontal LED lighting and ambient light, 3 touch sensors (On-Off/ Dimmer/ Colour temperature change 2700-6000K), aluminium frame, IP44

Spiegel, 1300 mm, mit integrierter horizontaler LED-Beleuchtung und Ambientelicht, 3 Touch Sensorschalter (An-Aus/ Dimmer/ Farbtemperaturwechsel 2700-6000K), Aluminiumrahmen, IP44

1300 x 32 x 700 mm

Farben: .144

Available from 2nd Quarter 2019

Verfügbar ab 2. Quartal 2019

447691 LEELO

Mirror, 1500 mm with integrated horizontal LED lighting, for room switch, aluminium frame, 4000K, IP44

Spiegel, 1500 mm, mit integrierter horizontaler LED-Beleuchtung, für Lichtschalter, Aluminiumrahmen, 4000K, IP44

1500 x 38 x 700 mm

Farben: .144

Available from 2nd Quarter 2019

Verfügbar ab 2. Quartal 2019

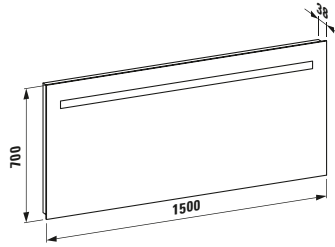

447692 LEELO

Mirror, 1500 mm with integrated horizontal LED lighting, 1 touch sensor (On/ Off/ Dimmer), aluminium frame, 4000K, IP44

Spiegel, 1500 mm, mit integrierter horizontaler LED-Beleuchtung, 1 Touch Sensorschalter (An/ Aus/ Dimmer), Aluminiumrahmen, 4000K, IP44

1500 x 38 x 700 mm

Farben: .144

Available from 2nd Quarter 2019

Verfügbar ab 2. Quartal 2019

447693 LEELO

Mirror, 1500 mm with integrated horizontal LED lighting and ambient light, 3 touch sensors (On-Off/ Dimmer/ Colour temperature change 2700-6000K), aluminium frame, IP44

Spiegel, 1500 mm, mit integrierter horizontaler LED-Beleuchtung und Ambientlicht, 3 Touch Sensorschalter (An-Aus/ Dimmer/ Farbtemperaturwechsel 2700-6000K), Aluminiumrahmen, IP44

1500 x 32 x 700 mm

Farben: .144

Available from 2nd Quarter 2019

Verfügbar ab 2. Quartal 2019

LEELO MIRRORS

447701 LEELO

Mirror, 1800 mm with integrated horizontal LED lighting, for room switch, aluminium frame, 4000K, IP44

Spiegel, 1800 mm, mit integrierter horizontaler LED-Beleuchtung, für Lichtschalter, Aluminiumrahmen, 4000K, IP44

1800 x 38 x 700 mm

Farben: .144

Available from 2nd Quarter 2019

Verfügbar ab 2. Quartal 2019

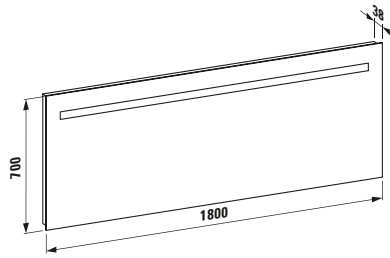

447702 LEELO

Mirror, 1800 mm with integrated horizontal LED lighting, 1 touch sensor (On/ Off/ Dimmer), aluminium frame, 4000K, IP44

Spiegel, 1800 mm, mit integrierter horizontaler LED-Beleuchtung, 1 Touch Sensorschalter (An/ Aus/ Dimmer), Aluminiumrahmen, 4000K, IP44

1800 x 38 x 700 mm

Farben: .144

Available from 2nd Quarter 2019

Verfügbar ab 2. Quartal 2019

447703 LEELO

Mirror, 1800 mm with integrated horizontal LED lighting and ambient light, 3 touch sensors (On-Off/ Dimmer/ Colour temperature change 2700-6000K), aluminium frame, IP44

Spiegel, 1800 mm, mit integrierter horizontaler LED-Beleuchtung und Ambientlicht, 3 Touch Sensorschalter (An-Aus/ Dimmer/ Farbtemperaturwechsel 2700-6000K), Aluminiumrahmen, IP44

1800 x 32 x 700 mm

Farben: .144

Available from 2nd Quarter 2019

Verfügbar ab 2. Quartal 2019

3113910041111

Single lever basin mixer, projection 106 mm, Eco+, fixed spout, with pop-up waste

Einhebel-Waschtischmischer, Ausladung 106 mm, Eco+, Festauslauf, mit Ablaufventil

Farben: .004

Available from 3rd Quarter 2019

Verfügbar ab 3. Quartal 2019

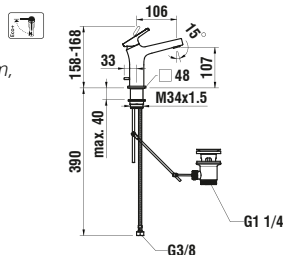

3113910041101

Single lever basin mixer, projection 106 mm, Eco+, fixed spout, without pop-up waste

Einhebel-Waschtischmischer, Ausladung 106 mm, Eco+, Festauslauf, ohne Ablaufventil

Farben: .004

Available from 3rd Quarter 2019

Verfügbar ab 3. Quartal 2019



3113910041211

Single lever basin mixer, projection 130 mm, Eco+, fixed spout, with pop-up waste

Einhebel-Waschtischmischer, Ausladung 130 mm, Eco+, Festauslauf, mit Ablaufventil

Farben: .004

Available from 3rd Quarter 2019

Verfügbar ab 3. Quartal 2019

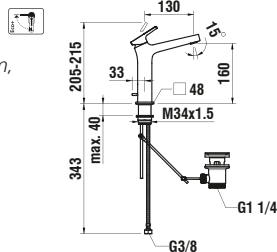

3113910041201

Single lever basin mixer, projection 130 mm, Eco+, fixed spout, without pop-up waste

Einhebel-Waschtischmischer, Ausladung 130 mm, Eco+, Festauslauf, ohne Ablaufventil

Farben: .004

Available from 3rd Quarter 2019

Verfügbar ab 3. Quartal 2019



3113980041201

Column single lever basin mixer, projection 170 mm, Eco+, fixed spout, without pop-up waste

Standsäulen-Einhebel-Waschtischmischer, Ausladung 170 mm, Eco+, Festauslauf, ohne Ablaufventil

Farben: .004

Available from 3rd Quarter 2019

Verfügbar ab 3. Quartal 2019

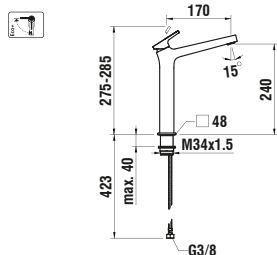

3413910041111

Single lever bidet mixer, projection 110 mm, Eco+, fixed spout, with pop-up waste

Einhebel-Bidetmischer, Ausladung 110 mm, Eco+, Festauslauf, mit Ablaufventil

Farben: .004

Available from 3rd Quarter 2019

Verfügbar ab 3. Quartal 2019

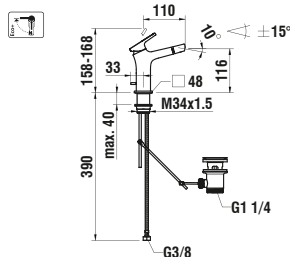

3213970041311

Wall-mounted single lever bath mixer, with 2-way diverter, with accessories

Aufputz-Einhebel-Bademischer, mit Umsteller für 2 Verbraucher, mit Zubehör

Farben: .004

Available from 3rd Quarter 2019

Verfügbar ab 3. Quartal 2019

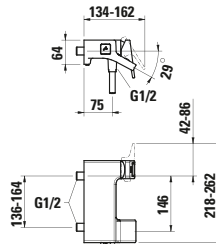

3213970044001

Wall-mounted single lever bath mixer, with 2-way diverter, without accessories

Aufputz-Einhebel-Bademischer, mit Umsteller für 2 Verbraucher, ohne Zubehör

Farben: .004

Available from 3rd Quarter 2019

Verfügbar ab 3. Quartal 2019

3313970041311

Wall-mounted single lever shower mixer, with one outlet, with accessories

Aufputz-Einhebel-Duschenmischer, für einen Verbraucher, mit Zubehör

Farben: .004

Available from 3rd Quarter 2019

Verfügbar ab 3. Quartal 2019

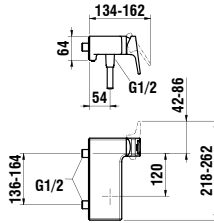

3313970044001

Wall-mounted single lever shower mixer, with one outlet, without accessories

Aufputz-Einhebel-Duschenmischer, für einen Verbraucher, ohne Zubehör

Farben: .004

Available from 3rd Quarter 2019

Verfügbar ab 3. Quartal 2019

3233960040001

Set for concealed single lever bath mixer, with 2-way diverter

Fertigmontageset für Unterputz-Einhebel-Bademischer, mit Umsteller für 2 Verbraucher

Farben: .004

Available from 3rd Quarter 2019

Verfügbar ab 3. Quartal 2019

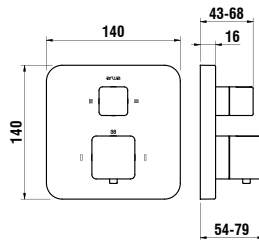

3233960040101

Set for concealed single lever bath mixer, with 2-way diverter, with integrated vacuum breaker

Fertigmontageset für Unterputz-Einhebel-Bademischer, mit Umsteller für 2 Verbraucher, mit integriertem Rohrunterbrecher

Farben: .004

Available from 3rd Quarter 2019

Verfügbar ab 3. Quartal 2019

3333960040001

Twin handled set for concealed thermostatic shower mixer, with one outlet

2-Griff-Fertigmontageset für thermostatischen Unterputz-Duschenmischer, für einen Verbraucher

Farben: .004

Available from 3rd Quarter 2019

Verfügbar ab 3. Quartal 2019

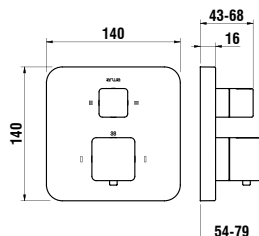

3713900040601

Wall-mounted spout, fixed spout, projection 126 mm

Wanneneinlauf, Festauslauf, Ausladung 126 mm

Farben: .004

Available from 3rd Quarter 2019

Verfügbar ab 3. Quartal 2019

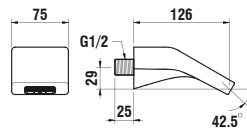

3613930041211

Hand shower, 1 shower jet

Handbrause, 1 Brausestrahl

Farben: .004

Available from 3rd Quarter 2019

Verfügbar ab 3. Quartal 2019

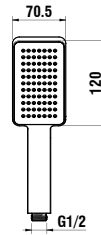

QUADRIGA

3112210911111

Single lever basin mixer, projection 115 mm,
fixed spout, with pop-up waste

*Einhebel-Waschtischmischer, Ausladung 115 mm,
Festauslauf, mit Ablaufventil*

Farben: .091*

Available from 3rd Quarter 2019

*brushed stainless steel

Verfügbar ab 3. Quartal 2019

*Edelstahl gebürstet

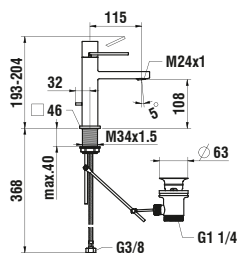

3112210911101

Single lever basin mixer, projection 115 mm,
fixed spout, without pop-up waste

*Einhebel-Waschtischmischer, Ausladung 115 mm,
Festauslauf, ohne Ablaufventil*

Farben: .091*

Available from 3rd Quarter 2019

*brushed stainless steel

Verfügbar ab 3. Quartal 2019

*Edelstahl gebürstet

311221xxx1211

Single lever basin mixer, projection 140 mm,
fixed spout, with pop-up waste

*Einhebel-Waschtischmischer, Ausladung 140 mm,
Festauslauf, mit Ablaufventil*

Farben: .004 .091*

Available from 3rd Quarter 2019

*brushed stainless steel

Verfügbar ab 3. Quartal 2019

*Edelstahl gebürstet

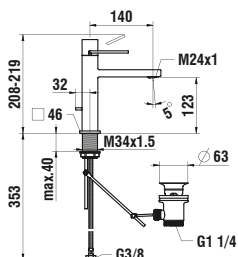

311221xxx1201

Single lever basin mixer, projection 140 mm,
fixed spout, with pop-up waste

*Einhebel-Waschtischmischer, Ausladung 140 mm,
Festauslauf, mit Ablaufventil*

Farben: .004 .091*

Available from 3rd Quarter 2019

*brushed stainless steel

Verfügbar ab 3. Quartal 2019

*Edelstahl gebürstet

311228xxx1201

Column single lever basin mixer, projection 190 mm,
fixed spout, without pop-up waste

*Standsäulen-Einhebel-Waschtischmischer,
Ausladung 190 mm, Festauslauf, ohne Ablaufventil*

Farben: .004 .091*

Available from 3rd Quarter 2019

*brushed stainless steel

Verfügbar ab 3. Quartal 2019

*Edelstahl gebürstet

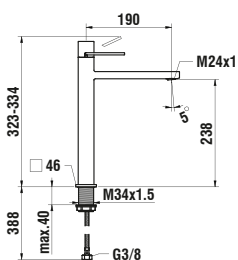

341221xxx1111

Single lever bidet mixer, fixed spout,
with pop-up waste

Einhebel-Bidetmischer, Festauslauf, mit Ablaufventil

Farben: .004 .091*

Available from 3rd Quarter 2019

*brushed stainless steel

Verfügbar ab 3. Quartal 2019

*Edelstahl gebürstet

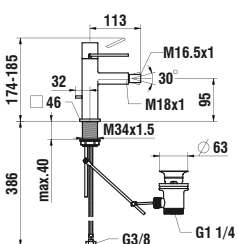

3212290911411

Single lever concealed bath mixer for Simibox 1-Point, with accessories

Einhebel-Unterputz-Bademischer für Simibox 1-Point, mit Zubehör

Farben: .091*

Available from 3rd Quarter 2019

*brushed stainless steel

Verfügbar ab 3. Quartal 2019

*Edelstahl gebürstet

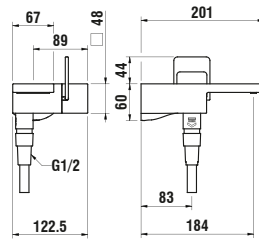

3312290911411

Single lever concealed shower mixer for Simibox 1-Point, with accessories

Einhebel-Unterputz-Duschenmischer für Simibox 1-Point, mit Zubehör

Farben: .091*

Available from 3rd Quarter 2019

*brushed stainless steel (PVD)

Verfügbar ab 3. Quartal 2019

*Edelstahl gebürstet (PVD)

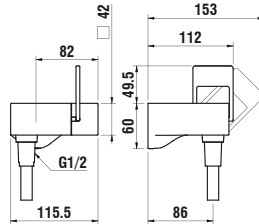

323226xxx0001

Twin handled set for concealed thermostatic bath/shower mixer, with 2-way diverter

2-Griff-Fertigmontageset für thermostatischen Unterputz-Bade-/Duschenmischer, mit Umsteller für 2 Verbraucher

Farben: .004 .090*

Available from 3rd Quarter 2019

*brushed stainless steel (PVD)

Verfügbar ab 3. Quartal 2019

*Edelstahl gebürstet (PVD)

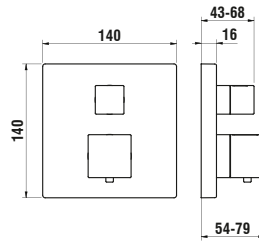

323226xxx0101

Twin handled set for concealed thermostatic bath/shower mixer, with 2-way diverter, with integrated vacuum breaker

2-Griff-Fertigmontageset für thermostatischen Unterputz-Bade-/Duschenmischer, mit Umsteller für 2 Verbraucher, mit integriertem Rohrunterbrecher

Farben: .004 .090*

Available from 3rd Quarter 2019

*brushed stainless steel (PVD)

Verfügbar ab 3. Quartal 2019

*Edelstahl gebürstet (PVD)

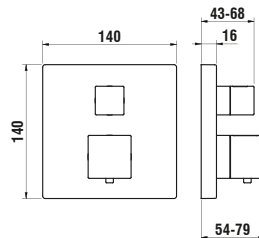

333226xxx0001

Twin handled set for concealed thermostatic shower mixer, with 2-way diverter

2-Griff-Fertigmontageset für thermostatischen Unterputz-Duschenmischer, mit Umsteller für 2 Verbraucher

Farben: .004 .090*

Available from 3rd Quarter 2019

*brushed stainless steel

Verfügbar ab 3. Quartal 2019

*Edelstahl gebürstet

QUADRIGA

3712200910601

Wall-mounted spout, fixed spout, projection 190mm

Wanneneinlauf, Festauslauf, Ausladung 190mm

Farben: .091*

Available from 3rd Quarter 2019

*brushed stainless steel

Verfügbar ab 3. Quartal 2019

*Edelstahl gebürstet

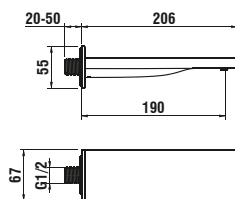

367221xxx1311

Square rain shower head, ultra flat, 300x300 mm

Quadratische Regenbrause, ultraflach, 300x300 mm

Farben: .004 .091*

Available from 3rd Quarter 2019

*Nickel brushed

Verfügbar ab 3. Quartal 2019

*Nickel gebürstet

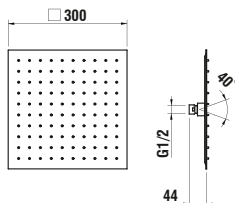

366220xxx0131

Wall bracket for rain shower head, 420mm

Brausewandarm für Regenbrause, 420 mm

Farben: .004 .007*

Available from 3rd Quarter 2019

*Nickel brushed

Verfügbar ab 3. Quartal 2019

*Nickel gebürstet

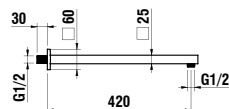

366220xxx0111

Ceiling bracket for rain shower head, 150mm

Brausedeckenarm für Regenbrause, 150 mm

Farben: .004 .007*

Available from 3rd Quarter 2019

*brushed stainless steel (PVD)

Verfügbar ab 3. Quartal 2019

*Edelstahl gebürstet (PVD)

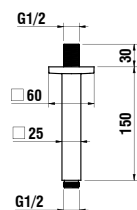

364980xxx5001

Shower slide bar, height 1030 mm

Duschgleitstange, Höhe 1030 mm

Farben: .004 .090*

Available from 3rd Quarter 2019

*brushed stainless steel

Verfügbar ab 3. Quartal 2019

*Edelstahl gebürstet

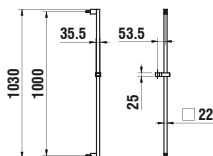

369220xxx3011

Fixed shower holder, all-metal

Fester Brausehalter, Vollmetall

Farben: .004 .091*

Available from 3rd Quarter 2019

*brushed stainless steel

Verfügbar ab 3. Quartal 2019

*Edelstahl gebürstet

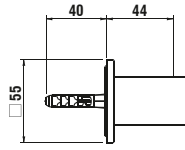

363220xxx1611

Shower hose connector, with check-valve

Anschlussbogen, mit Rückflussverhinderer

Farben: .004 .091*

Available from 3rd Quarter 2019

*brushed stainless steel

Verfügbar ab 3. Quartal 2019

*Edelstahl gebürstet

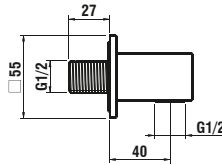

363220xxx1621

Shower hose connector with integrated shower holder, with vacuum breaker

Anschlussbogen mit integriertem Brausehalter, mit Rohrunterbrecher

Farben: .004 .091*

Available from 3rd Quarter 2019

*brushed stainless steel (PVD)

Verfügbar ab 3. Quartal 2019

*Edelstahl gebürstet (PVD)

361983xxx1211

Hand shower, 1 shower jet

Handbrause, 1 Brausestrahl

Farben: .004 .090*

Available from 3rd Quarter 2019

Verfügbar ab 3. Quartal 2019

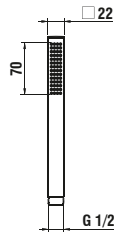

NOTIZEN

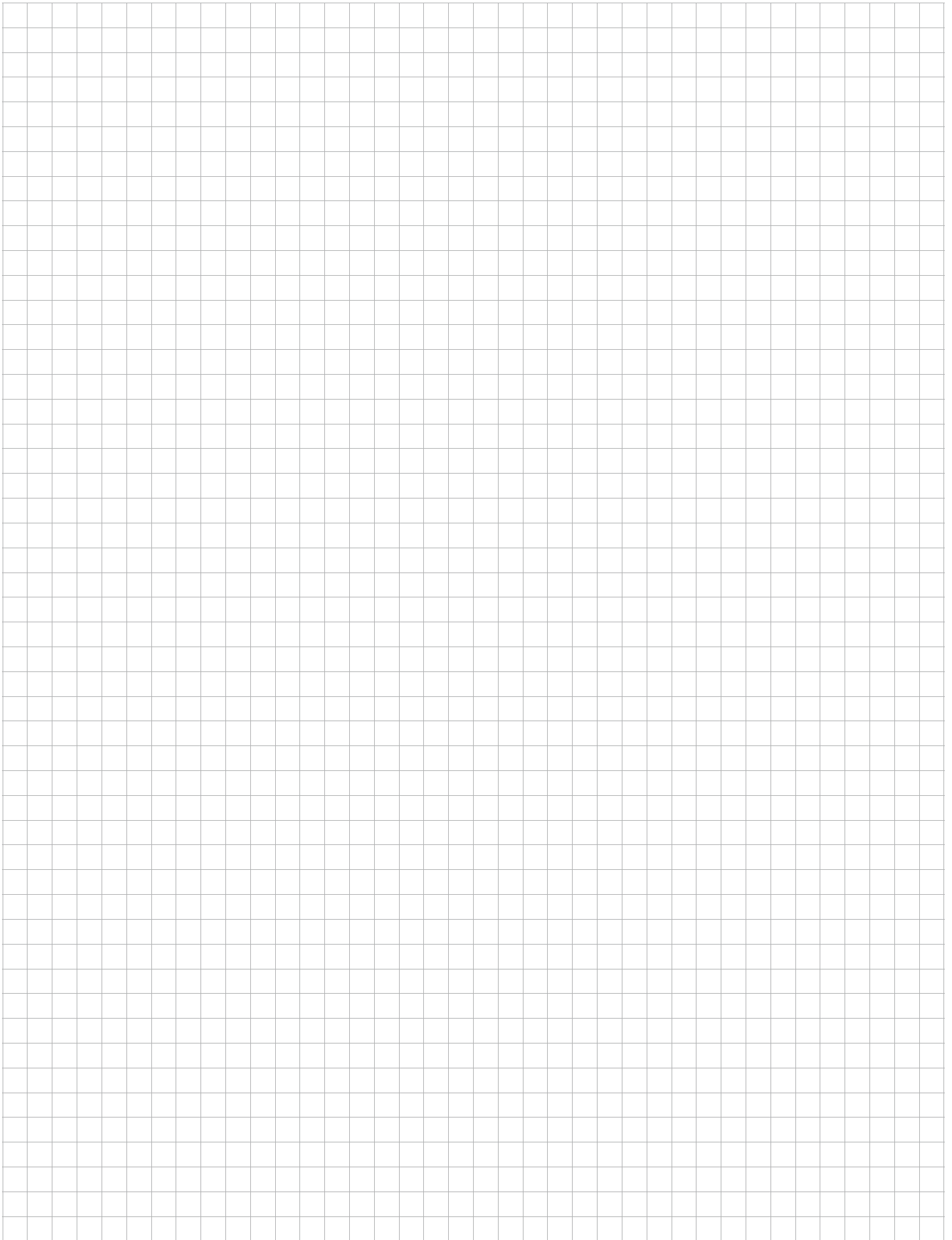

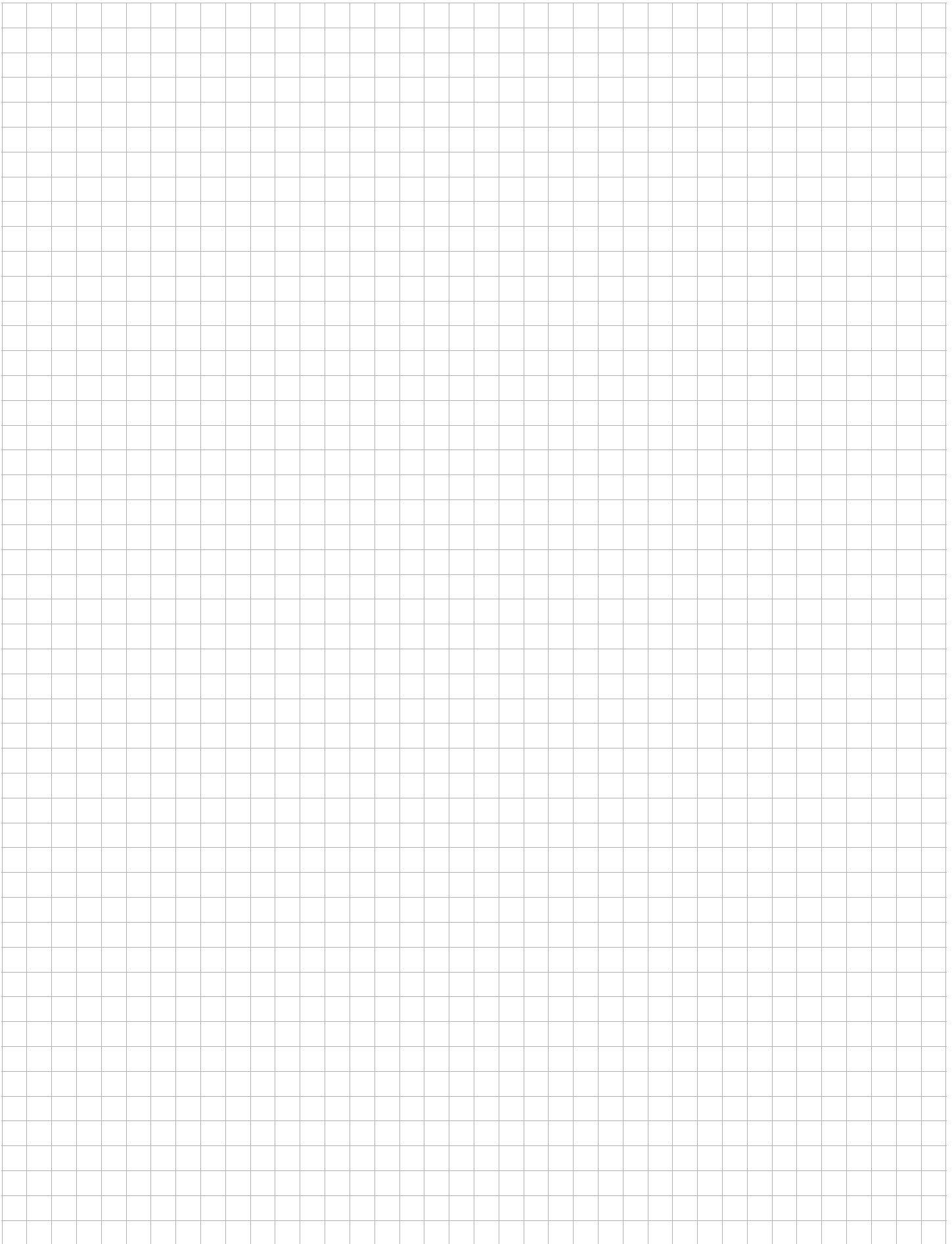

NOTIZEN

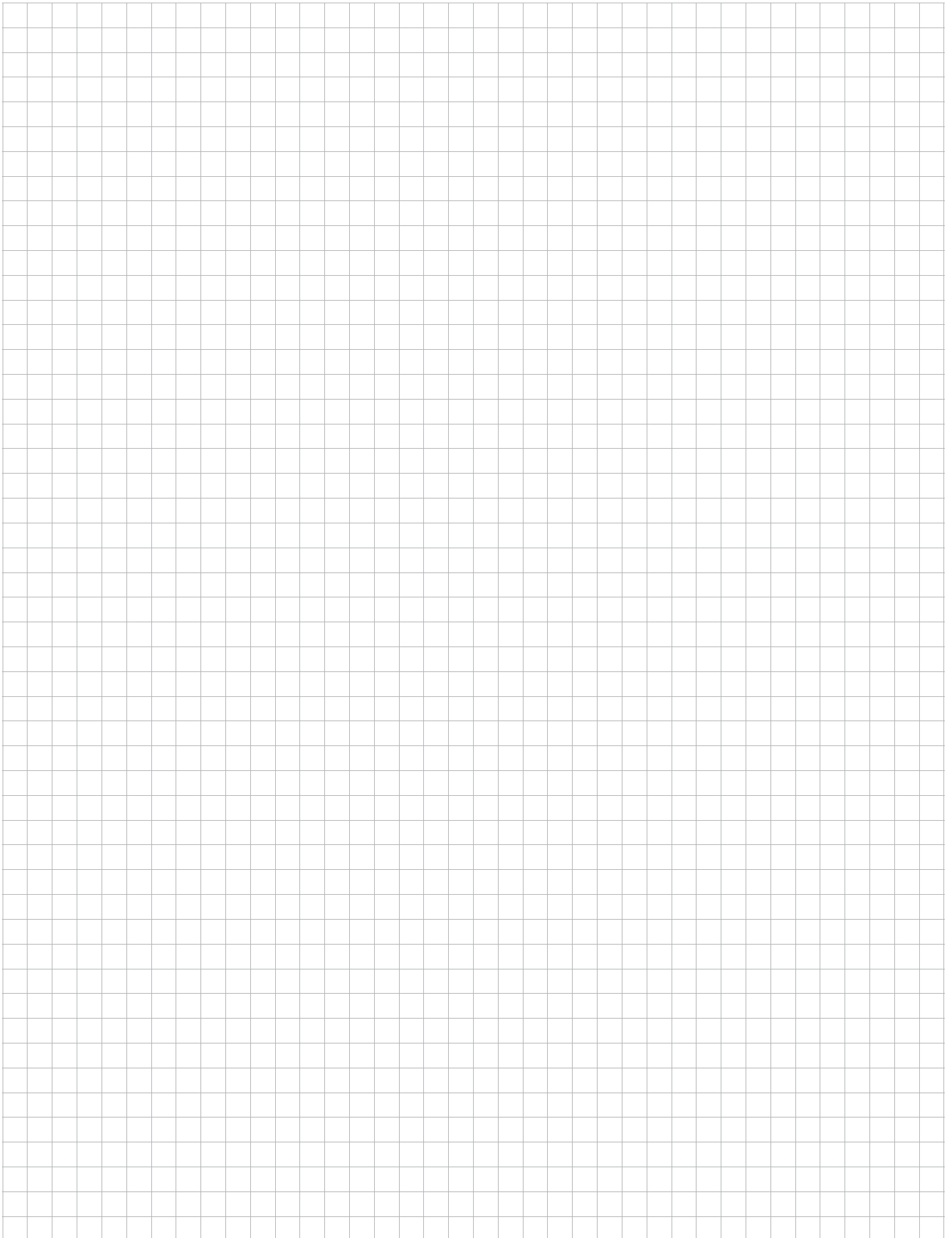



www.laufen.com



www.news.laufen.com



www.laufen.com/bimobjects
www.facebook.com/laufenbathrooms
www.twitter.com/laufenbathrooms
www.youtube.com/laufenbathrooms1
www.instagram.com/laufenbathrooms
www.pinterest.com/laufenbathrooms